

DRAWING NO. SD031189	7					6					5					4					3					2					1				
	CATALOG NUMBER	STRANDED COPPER CONDUCTOR ACCOMMODATED	BOLT SIZE	METRIC BOLT SIZE	DIMENSIONS												TOLERANCE BLOCK																		
CODE (AWG)	NAVY	METRIC SIZE (CLASS 2)	B	C	E	K DIA.	L	N	O.D.	T REF.	Z MIN.																								
YA8C2N	#8 AWG	23	10mm ² STR [4.1] CLASS 2 & 5	1/2	M12	.81 [21]	↑	↑	↑	4.08 [104]	↑	.27 [7]	↑	↑																					
YA6C2N	#6 AWG	----	----	1/2	M12	1.12 [28]	↑	↑	↑	4.40 [112]	↑	.29 [7]	↑	↑																					
YA5C2N	#5 AWG	30	16mm ² STR [5.3]	1/2	M12					4.43 [113]		.30 [8]																							
YA4C2N	#4 AWG	40	----	1/2	M12					4.45 [113]		.34 [9]																							
YA3C2N	#3 AWG #2 SOL	50	25mm ² STR [6.6]	1/2	M12	1.25 [32]	↓	↓	↓	4.62 [117]	↓	.38 [8]	↓	↓																					
YA2C2N	#2 AWG	60	----	1/2	M12					4.64 [118]		.42 [11]																							

CATALOG NO.	COLOR CODE	DIE INFORMATION		MECHANICAL RATCHET								HYDRAULIC						DIELESS (# CRIMPS)	WIRE STRIP LENGTH
		DIE INDEX	TYPE	YIMRTC	OUR840	MD6 MD7	MD6--R2	MD7-34R	Y500CT PAT600	Y34A Y34B Y34BH	Y35, Y39, Y750, PAT750	Y46	Y45	Y48B	Y60BHU				
YA8C2N	RED	49	RED DIE SET	RED (2)	X8CRT(1) W8CVT(1)	W8CRT(1) W8CVT(1)	W8CRT(1) W8CVT(1)	W8CRT(1) W8CVT(1)	W8CRT(1) W8CVT(1)	X8CRT(2) W8CRT(1) W8CVT(1)	-----	U8CRT (1)	U8CRT (1)	U8CRT (1)	-----	-----	RATCHET: Y8MRB-1(1) MECHANICAL: MY29-3(1), MY29-11(1), MRC-840(2) HYDRAULIC: Y81K-SERIES(1) PAT81K-SERIES(1) Y81KFT-SERIES(2) Y4PC834-SERIES(2)	7/8"	
YA6C2N YA5C2N	BLUE	7 374	BLUE DIE SET	BLUE (2)	X5CRT(2)	W5CRT(2) W5CVT(2)	W5CRT(2) W5CVT(2)	W5CRT(2) W5CVT(2)	W5CRT(2) W5CVT(2)	X5CRT(2) W5CRT(2) W5CVT(2)	----- B6CD(1) A6CD(1) Y34PR	U5CRT(2) U8CABT(2)	U5CRT(2) U8CABT(2)	U5CRT(2) U8CABT(2)	-----	-----	MECHANICAL: MY29-3(2) MY29-11(2) MRC-840(2) HYDRAULIC: Y644M(1) PAT644M(1) Y81K-SERIES(1) PAT81K-SERIES(1) Y81KFT-SERIES(2) Y4PC834-SERIES(2)	1-3/16"	
YA4C2N	GRAY	8 346	GRAY DIE SET	GRAY(4)	X4CRT(2)	W4CRT(2) W4CVT(2)	W4CRT(2) W4CVT(2)	W4CRT(2) W4CVT(2)	W4CRT(2) W4CVT(2)	X4CRT(2) W4CRT(2) W4CVT(2)	----- B4CD(1) A4CD(1) Y34PR	U4CRT(2) U4CABT(2)	U4CRT(2) U6CABT(2)	U4CRT(2) U6CABT(2)	-----	-----		1-3/16"	
YA3C2N	WHITE	9	WHITE DIE SET	WHITE(4)	W3CRT(2)	W3CRT(2)	W3CRT(2)	W3CRT(2)	W3CRT(2)	W3CRT(2)	----- B3CD(1) A3CD(1) Y34PR	U3CRT(2)	U3CRT(2)	U3CRT(2)	-----	-----		1-5/16"	
YA2C2N	BROWN	10	BROWN DIE SET	BROWN(4)	X2CRT(2)	W2CRT(2) W2CVT(2)	W2CRT(2) W2CVT(2)	W2CRT(2) W2CVT(2)	W2CRT(2) W2CVT(2)	X2CRT(2) W2CRT(2) W2CVT(2)	----- B2CD(1) A2CD(1) Y34PR	U2CRT(2)	U2CRT(2)	U2CRT(2)	-----	-----		1-5/16"	

- NOTES:
1. MATERIAL: COPPER TUBING
 2. FINISH: TIN PLATED. FOR UNPLATED VERSION, ADD SUFFIX "BR" TO CATALOG NUMBER EX. YA6C2NBR.
 3. CATALOG # PT6515 ADAPTOR IS REQUIRED TO USE "U" DIES IN Y45 SERIES TOOLS.
 4. CATALOG # PUADP-1 ADAPTOR IS REQUIRED TO USE "U" DIES IN Y46 SERIES TOOLS.
 5. Y35P3 INDENTOR ADAPTOR REQUIRED FOR Y34PR INDENTOR.
 6. PERMANENT DIE IN TOOLING.
 7. DIMENSIONS IN BRACKETS [] ARE IN MILLIMETERS ROUNDED OFF TO THE NEAREST MILLIMETER, UNLESS OTHERWISE NOTED, AND ARE FOR REFERENCE ONLY.
 8. FOR USE BY CUSTOMERS THAT HAVE THIS HYPRESS™ NO NEW Y34A HYPRESS™ TOOLS ARE BEING PROCESSED. Y34A USES A--D TYPE NEST DIES.
 9. CONNECTORS ARE UL LISTED; UNDRILLED VERSIONS ARE NOT UL LISTED.
 10. CONNECTORS ARE CSA CERTIFIED; UNDRILLED VERSIONS ARE NOT CSA CERTIFIED.
 11. FOR UNDRILLED VERSIONS ADD SUFFIX "-U" TO END OF CATALOG NUMBER. FOR UNDRILLED VERSIONS, USE D MIN. = N MAX. + E MIN. + Z MIN.
 12. "X", "W-RT", "W-VT", "U", & "L" DIE SETS ARE COLOR CODED. "A", "B", AND "C" DIES ARE NOT COLOR CODED. NESTS AND INDENTOR TYPE ARE NOT COLOR CODED.
 13. X8CABT & U8CABT DIES USED ON YA6C-- HYLUG™ NOT YA5C-- HYLUG™

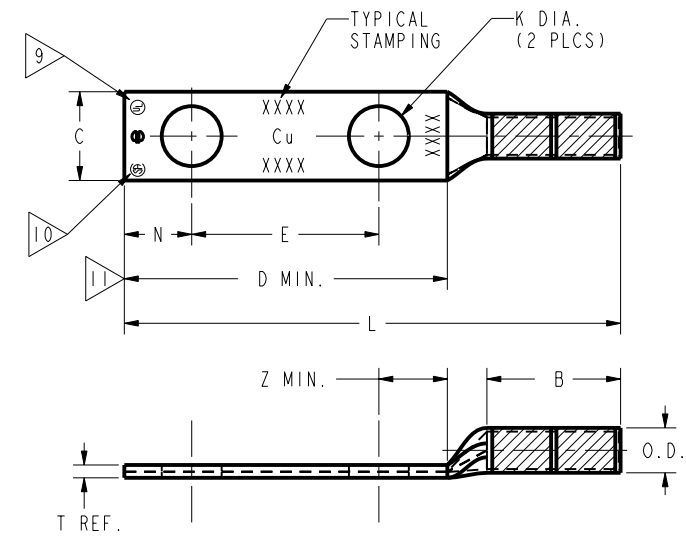

REFERENCE: SE209513

TO ORDER BURNDY® PRODUCTS CALL

UNITED STATES
1-800-346-4175 (LONDONDERRY, NH)

CANADA:
1-800-361-6975 (QUEBEC)
1-800-387-6487 (ALL OTHER PROVINCES)

FOR PRODUCT INFO: <http://www.burndy.com>

HYLUG™	
ITEM NO:	N/A
CAT. NO:	YA--2N (SEE TABLE)
DRAWN BY:	J MICHAUD 11/18/94
CHECKER:	D FILLION 11/18/94
DSN APPVL:	C PALAGI 10/24/94
MFG APPVL:	--
QA APPVL:	C ACKERMAN 11/17/94
MKT APPVL:	T NELSON 11/10/94
PROD FAM:	CM&R COMPRESSION
PROJECT #:	--
DOCUMENT TYPE:	Sales
REL LEVEL:	Released
DRAWING NO	SD031189
SCALE:	NTS
REV	C
SHEET	1 OF 10

REV: PEO200