

**Industrial LED luminaires**  
Exit and Emergency

**Sure-Lites**



**EATON**

*Powering Business Worldwide*

# SEL/SELM Indoor

WAREHOUSE / DISTRIBUTION | MANUFACTURING | GYMNASIUMS / MULTI-PURPOSE ROOMS / ATHLETIC CENTER | BIG BOX / RETAIL

SEL



Polycarbonate

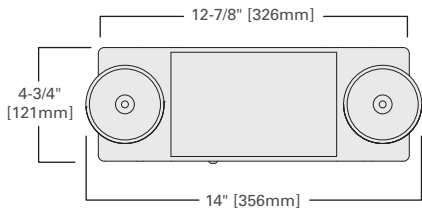

SELM



Metal

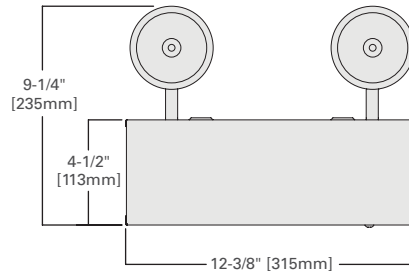

Feature	Benefit
Up to 60 feet of egress coverage	Up to \$300 savings on installation
LED source with Nickel cadmium battery	Up to ten years with no maintenance
Optional remote capacity	Indoor, outdoor design flexibility
Self diagnostics w/laser test	Reduce labor of NFPA/OSHA testing

Certification/warranty
UL924 damp location
NFPA 101 compliant
NEC/OSHA compliant
5-year product warranty
7-year prorated battery warranty

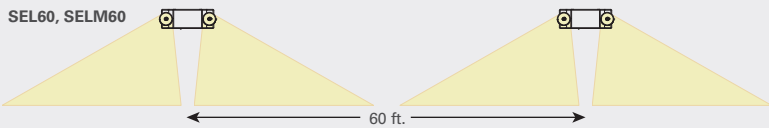

# SELW/SELD Outdoor

WAREHOUSE / DISTRIBUTION | MANUFACTURING | GYMNASIUMS / MULTI-PURPOSE ROOMS / ATHLETIC CENTER | BIG BOX / RETAIL

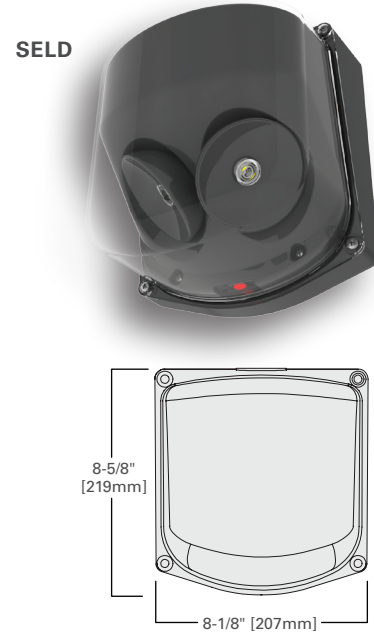
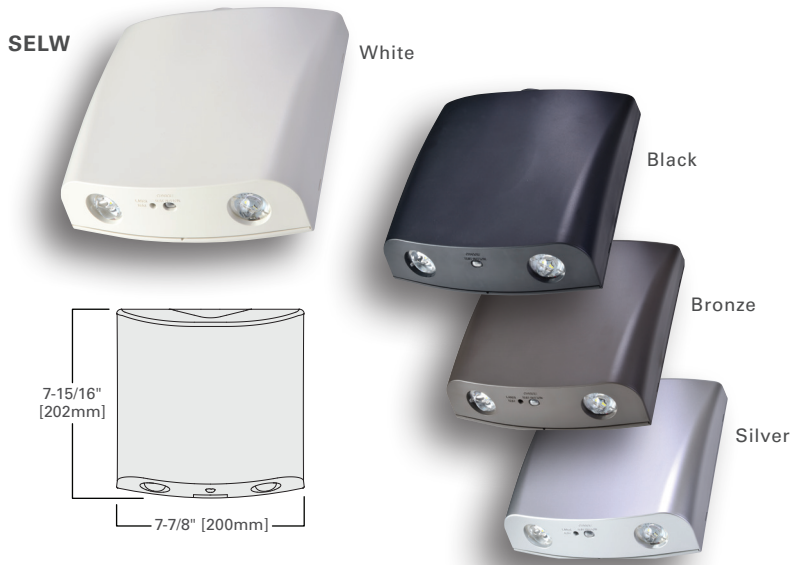

Feature	Benefit
LED source with Nickel cadmium battery	Up to ten years with no maintenance
Forward throw optic	Maximum design flexibility
29 feet spacing	Less fixtures required
Self diagnostics w/laser test	Reduce labor of NFPA/OSHA testing

Feature	Benefit
LED source with Nickel cadmium battery	Up to ten years with no maintenance
58 foot spacing	Less fixtures required
Standard Self diagnostics with laser test	Reduce labor of NFPA/OSHA testing
NEMA 4X; IP66; - 30° C to 50° C	Maximum design flexibility

Certification/warranty
UL924 wet location
NFPA 101 compliant
NEC/OSHA compliant
5-year product warranty
7-year prorated battery warranty

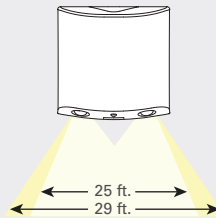

Certification
UL924 wet location
NEMA 4X
NFPA 101 compliant
NEC/OSHA compliant
IP66
NSF
IP66HAZ (class 1, Div 2) option

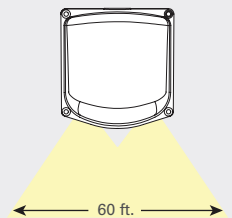

## LPX Exit

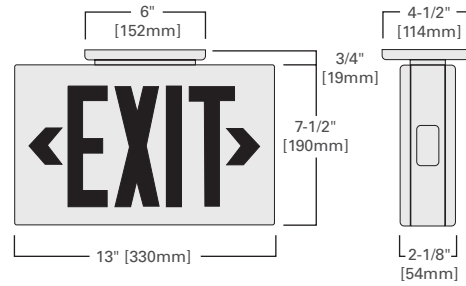

Feature	Benefit
LED source with Nickel cadmium battery	Up to ten years with no maintenance
Field adjustable for red or green	Maximum design flexibility
Optional emergency heads or remote capacity	Less fixtures required
Standard Self diagnostics with laser test	Reduce labor of NFPA/OSHA testing

Certification/warranty
UL924 damp location
NFPA 101 compliant
NEC/OSHA compliant
5-year product warranty
7-year prorated battery warranty



## LPX LED Combo

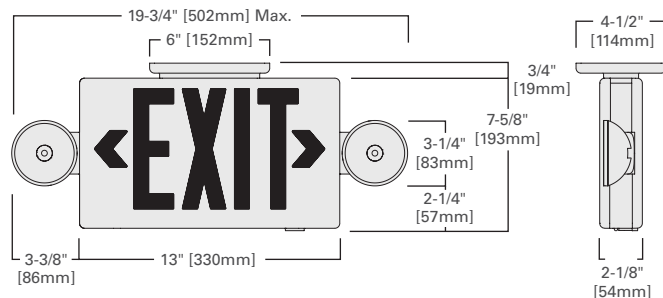

UX Exit

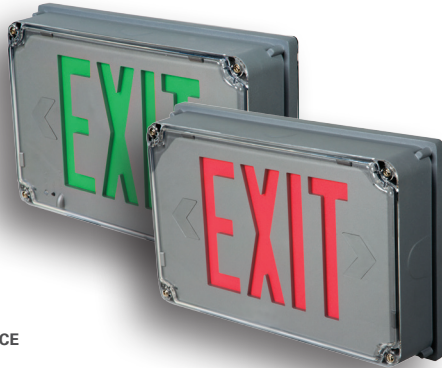

SINGLE FACE

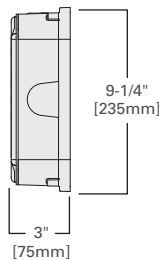
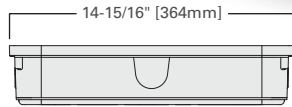

LPWX Exit

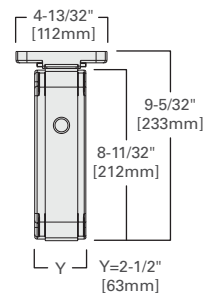
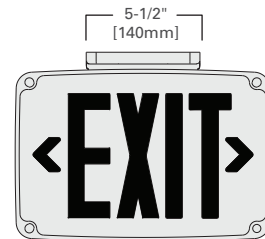
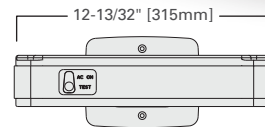

Feature	Benefit
LED source with Nickel cadmium battery	Up to ten years with no maintenance
Field adjustable for red or green	Maximum design flexibility
Standard Self diagnostics with laser test	Reduce labor of NFPA/OSHA testing
NEMA 4X; IP66; - 30° C to 50° C	Maximum design flexibility

Certification/warranty
UL924 wet location
NEMA 4X/IP66
NFPA 101 compliant
NEC/OSHA/NSF compliant
HAZ (class 1, Div 2) rated option
NSF
5-year product warranty, 7-year prorated battery warranty

Feature	Benefit
LED source with Nickel cadmium battery	Up to ten years with no maintenance
UV stabilized polycarbonate housing	Outdoor capable
Standard Self diagnostics with laser test	Reduce labor of NFPA/OSHA testing
Wet location listed; - 30° C to 50° C	Maximum design flexibility

Certification/warranty
UL924 wet location
NFPA 101 compliant
NEC/OSHA compliant
5-year product warranty, 7-year prorated battery warranty



**Lighting Product Lines**

Halo  
Halo Commercial  
Portfolio  
Iris  
RSA  
Metalux  
Corelite  
Neo-Ray  
Fail-Safe  
MWS  
Ametrix  
Shaper  
io  
Lumark  
McGraw-Edison  
Invue  
Ephesus  
Lumière  
Streetworks  
AtLite  
Sure-Lites

**Controls Product Lines**

Greengate  
iLumin  
Zero 88  
Fifth Light Technology  
iLight (International Only)

**Connected Lighting Systems**

LumaWatt Pro  
WaveLinx  
Distributed Low-Voltage Power  
ConnectWorks

**Eaton**  
1121 Highway 74 South  
Peachtree City, GA 30269  
P: 770-486-4800  
[www.eaton.com/lighting](http://www.eaton.com/lighting)

**Canada Sales**  
5925 McLaughlin Road  
Mississauga, Ontario L5R 1B8  
P: 905-501-3000  
F: 905-501-3172

© 2017 Eaton  
All Rights Reserved  
Printed in USA  
Publication No. BR505013EN  
June 1, 2017

Eaton is a registered trademark.

All other trademarks are property  
of their respective owners.

Product availability, specifications,  
and compliances are subject to  
change without notice.

**Industrial LED luminaires**  
Exit and Emergency

**Sure-Lites**



**EATON**

*Powering Business Worldwide*

# SEL/SELM Indoor

WAREHOUSE / DISTRIBUTION | MANUFACTURING | GYMNASIUMS / MULTI-PURPOSE ROOMS / ATHLETIC CENTER | BIG BOX / RETAIL

SEL



Polycarbonate

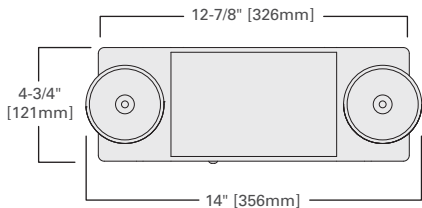

SELM



Metal

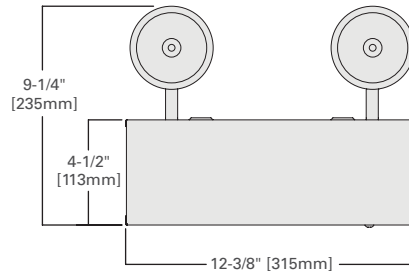

Feature	Benefit
Up to 60 feet of egress coverage	Up to \$300 savings on installation
LED source with Nickel cadmium battery	Up to ten years with no maintenance
Optional remote capacity	Indoor, outdoor design flexibility
Self diagnostics w/laser test	Reduce labor of NFPA/OSHA testing

Certification/warranty
UL924 damp location
NFPA 101 compliant
NEC/OSHA compliant
5-year product warranty
7-year prorated battery warranty

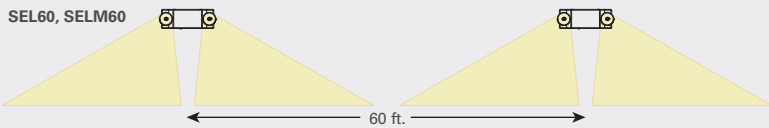



# SELW/SELD Outdoor

WAREHOUSE / DISTRIBUTION | MANUFACTURING | GYMNASIUMS / MULTI-PURPOSE ROOMS / ATHLETIC CENTER | BIG BOX / RETAIL

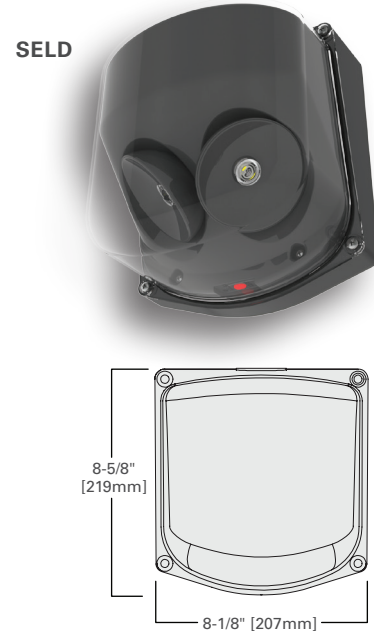
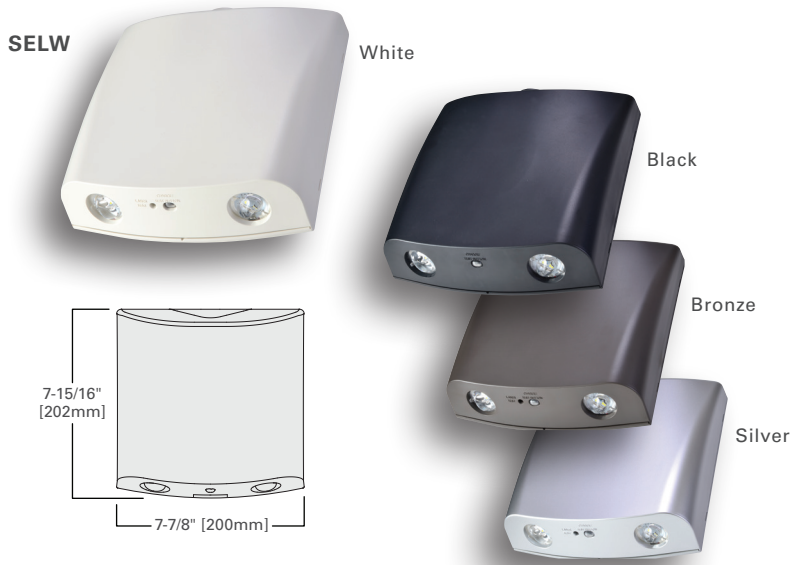

Feature	Benefit
LED source with Nickel cadmium battery	Up to ten years with no maintenance
Forward throw optic	Maximum design flexibility
29 feet spacing	Less fixtures required
Self diagnostics w/laser test	Reduce labor of NFPA/OSHA testing

Feature	Benefit
LED source with Nickel cadmium battery	Up to ten years with no maintenance
58 foot spacing	Less fixtures required
Standard Self diagnostics with laser test	Reduce labor of NFPA/OSHA testing
NEMA 4X; IP66; - 30° C to 50° C	Maximum design flexibility

Certification/warranty
UL924 wet location
NFPA 101 compliant
NEC/OSHA compliant
5-year product warranty
7-year prorated battery warranty

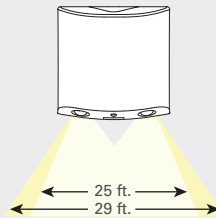

Certification
UL924 wet location
NEMA 4X
NFPA 101 compliant
NEC/OSHA compliant
IP66
NSF
IP66HAZ (class 1, Div 2) option

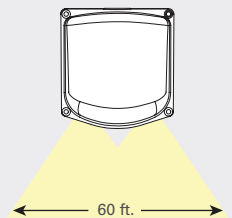

## LPX Exit

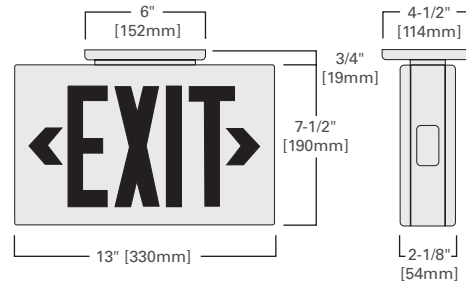

Feature	Benefit
LED source with Nickel cadmium battery	Up to ten years with no maintenance
Field adjustable for red or green	Maximum design flexibility
Optional emergency heads or remote capacity	Less fixtures required
Standard Self diagnostics with laser test	Reduce labor of NFPA/OSHA testing

Certification/warranty
UL924 damp location
NFPA 101 compliant
NEC/OSHA compliant
5-year product warranty
7-year prorated battery warranty



## LPX LED Combo

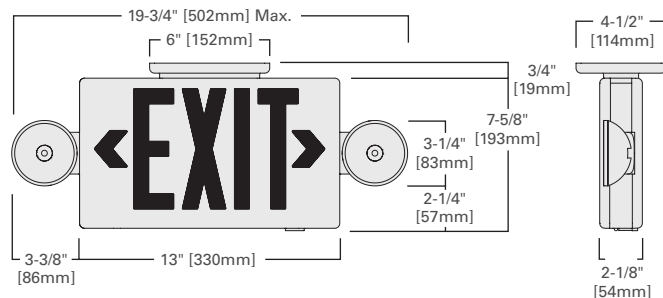

UX Exit

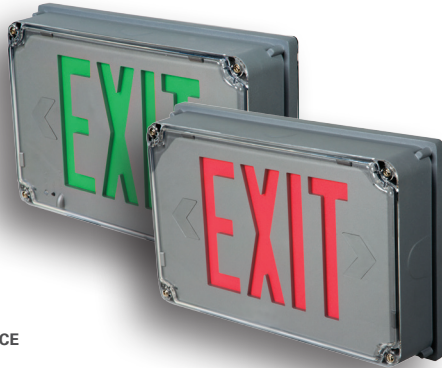

SINGLE FACE

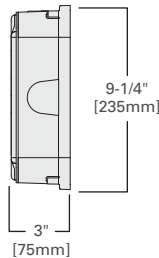
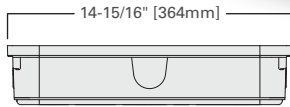

LPWX Exit

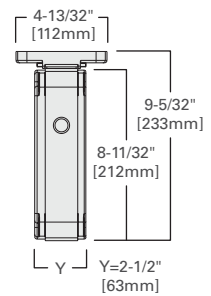
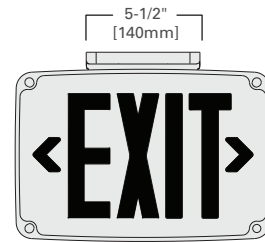
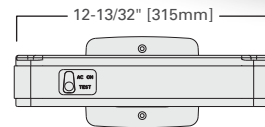

Feature	Benefit
LED source with Nickel cadmium battery	Up to ten years with no maintenance
Field adjustable for red or green	Maximum design flexibility
Standard Self diagnostics with laser test	Reduce labor of NFPA/OSHA testing
NEMA 4X; IP66; - 30° C to 50° C	Maximum design flexibility

Certification/warranty
UL924 wet location
NEMA 4X/IP66
NFPA 101 compliant
NEC/OSHA/NSF compliant
HAZ (class 1, Div 2) rated option
NSF
5-year product warranty, 7-year prorated battery warranty

Feature	Benefit
LED source with Nickel cadmium battery	Up to ten years with no maintenance
UV stabilized polycarbonate housing	Outdoor capable
Standard Self diagnostics with laser test	Reduce labor of NFPA/OSHA testing
Wet location listed; - 30° C to 50° C	Maximum design flexibility

Certification/warranty
UL924 wet location
NFPA 101 compliant
NEC/OSHA compliant
5-year product warranty, 7-year prorated battery warranty



**Lighting Product Lines**

Halo  
Halo Commercial  
Portfolio  
Iris  
RSA  
Metalux  
Corelite  
Neo-Ray  
Fail-Safe  
MWS  
Ametrix  
Shaper  
io  
Lumark  
McGraw-Edison  
Invue  
Ephesus  
Lumière  
Streetworks  
AtLite  
Sure-Lites

**Controls Product Lines**

Greengate  
iLumin  
Zero 88  
Fifth Light Technology  
iLight (International Only)

**Connected Lighting Systems**

LumaWatt Pro  
WaveLinx  
Distributed Low-Voltage Power  
ConnectWorks

**Eaton**

1121 Highway 74 South  
Peachtree City, GA 30269  
P: 770-486-4800  
[www.eaton.com/lighting](http://www.eaton.com/lighting)

**Canada Sales**

5925 McLaughlin Road  
Mississauga, Ontario L5R 1B8  
P: 905-501-3000  
F: 905-501-3172

© 2017 Eaton  
All Rights Reserved  
Printed in USA  
Publication No. BR505013EN  
June 1, 2017

Eaton is a registered trademark.

All other trademarks are property  
of their respective owners.

Product availability, specifications,  
and compliances are subject to  
change without notice.



*Powering Business Worldwide*