

Calbrite™

Stainless Steel Conduit Systems

Stainless Steel One Hole Straps

Features:

- Manufactured in type 316 stainless steel to meet any stringent sanitary condition
- Polished with standard "brite" finish to increase corrosion resistance and aesthetic appearance
- Designed for use with stainless rigid, stainless IMC, galvanized, & aluminum conduit
- No package qty. required



Certifications and Compliances:

Calbrite stainless steel One Hole Straps are fabricated to UL standards. Manufactured in the United States.

Applications:

Heavy duty type 316 stainless steel one-hole mount straps are great for securing and mounting conduit, tubing, & cable in corrosive environments.

Industries Commonly Served:

- Food & Beverage Production & Distribution
- Chemical Plants
- Water & Wastewater Treatment
- Pharmaceuticals & Cosmetics
- Refining & Extraction Sites
- Petrochemical Operations
- Marine & Coastal Facilities
- Pulp and Paper Mills
- Along with other corrosive environments

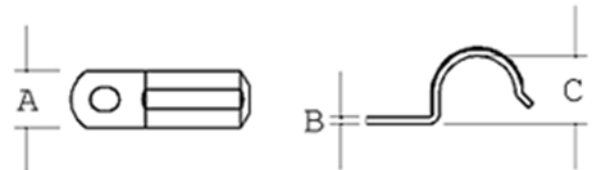

Size	Part Number	A	B	C	Bolt Hole Size	Weight (ea) per lb.
1/2"	S605001S00	0.750"	0.060"	0.840"	1/4"	0.03
3/4"	S607001S00	0.750"	0.080"	1.050"	1/4"	0.05
1"	S610001S00	0.750"	0.080"	1.300"	1/4"	0.06
1-1/4"	S612001S00	0.875"	0.100"	1.660"	1/2"	0.11
1-1/2"	S615001S00	0.880"	0.125"	1.900"	1/2"	0.17
2"	S620001S00	0.880"	0.125"	2.370"	1/2"	0.22
2-1/2"	S625001S00	1.250"	0.190"	2.874"	9/16"	0.55
3"	S630001S00	1.250"	0.190"	3.500"	9/16"	0.64
4"	S640001S00	1.250"	0.190"	4.500"	9/16"	0.76

*All dimensions are for informational purposes only * Tolerances +/- 5%*

Calbrite™

Stainless Steel Conduit Systems

Stainless Steel One Hole Straps

Features:

- Manufactured in type 316 stainless steel to meet any stringent sanitary condition
- Polished with standard "brite" finish to increase corrosion resistance and aesthetic appearance
- Designed for use with stainless rigid, stainless IMC, galvanized, & aluminum conduit
- No package qty. required



Certifications and Compliances:

Calbrite stainless steel One Hole Straps are fabricated to UL standards. Manufactured in the United States.

Applications:

Heavy duty type 316 stainless steel one-hole mount straps are great for securing and mounting conduit, tubing, & cable in corrosive environments.

Industries Commonly Served:

- Food & Beverage Production & Distribution
- Chemical Plants
- Water & Wastewater Treatment
- Pharmaceuticals & Cosmetics
- Refining & Extraction Sites
- Petrochemical Operations
- Marine & Coastal Facilities
- Pulp and Paper Mills
- Along with other corrosive environments

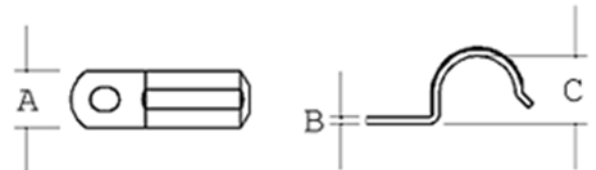

Size	Part Number	A	B	C	Bolt Hole Size	Weight (ea) per lb.
1/2"	S605001S00	0.750"	0.060"	0.840"	1/4"	0.03
3/4"	S607001S00	0.750"	0.080"	1.050"	1/4"	0.05
1"	S610001S00	0.750"	0.080"	1.300"	1/4"	0.06
1-1/4"	S612001S00	0.875"	0.100"	1.660"	1/2"	0.11
1-1/2"	S615001S00	0.880"	0.125"	1.900"	1/2"	0.17
2"	S620001S00	0.880"	0.125"	2.370"	1/2"	0.22
2-1/2"	S625001S00	1.250"	0.190"	2.874"	9/16"	0.55
3"	S630001S00	1.250"	0.190"	3.500"	9/16"	0.64
4"	S640001S00	1.250"	0.190"	4.500"	9/16"	0.76

*All dimensions are for informational purposes only * Tolerances +/- 5%*