

LED Retrofit
LT4 / LT56

HALO



EATON

Powering Business Worldwide

LT4 4" LED Retrofit Downlight



- Up to 601 lumens (5000K)
- Use to replace 60W PAR16 lamp
- 2700K, 3000K, 3500K, 4000K, 5000K Correlated Color Temperature (CCT)
- 90 CRI
- 7.5W - 8.0W (per CRI and CCT), 120V
- Halo matte white finish
- Push-N-Twist universal installation clips pre-installed
- Compatible with most 4" recessed housings
- Includes Edison base adapter
- Dimmable to 10% with select dimmers
- Damp and wet location listed (shower rated)
- Rated for IC, ICAT and may be used in Non-IC housings
- AIR-TITE™ certified per ASTM-E283-04
- Diffusing, regressed lens
- Five-year limited warranty

LT4 Energy Data

Input Voltage	120V
Input Frequency	50/60 Hz
Input Power	7.5W - 8.0W (per CRI and CCT)
Input Current	0.065A - 0.069A (per Input power)
Power Factor	>0.90
THD	≤23.5%
Sound Rating	Class A
T Ambient	-30°C (-22°F) to 40°C (104°F)



Refer to ENERGY STAR® Qualified Products List.
Can be used to comply with California Title 24
High Efficacy requirements.
Certified to California Appliance Efficiency
Database under JA8.



Ordering Information

Sample Number: **LT460WH6930**

Order Halo housing separately.

LT4 Models

LT460WH6927= 4" Retrofit Baffle - Trim LED Module, 90 CRI, 2700K, Matte White

LT460WH6930= 4" Retrofit Baffle - Trim LED Module, 90 CRI, 3000K, Matte White

LT460WH6935= 4" Retrofit Baffle - Trim LED Module, 90 CRI, 3500K, Matte White

LT460WH6940= 4" Retrofit Baffle - Trim LED Module, 90 CRI, 4000K, Matte White

LT460WH6950= 4" Retrofit Baffle - Trim LED Module, 90 CRI, 5000K, Matte White

LED Housings (Order Separately)

See Housing Compatibility, Page 6

Accessories (Order Separately)

HE26LED=Replacement screw base adapter
(one included with unit)



HE26LED
Edison Base Adapter
for retrofit (included)

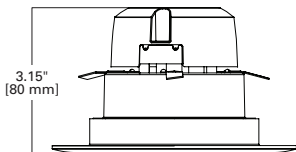

3.15"
[80 mm]

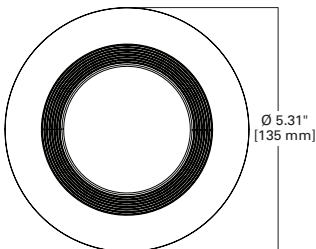

Ø 5.31"
[135 mm]

UP TO **\$373^Δ**
SAVINGS

^Δ Savings are over the life of the Halo LT4 luminaire.

Energy savings: \$283

Replacement lamp savings: \$90

Savings based on \$0.155 per kilowatt hour, average 6 hours use per day, 35,000 hours of lamp usage, and 60W PAR16 Halogen lamp lumen equivalent.



LT56 5" / 6" LED Retrofit Downlight



- Up to 772 lumens (5000K)
- Use to replace 65W BR30 or 50W PAR30 lamp
- 2700K, 3000K, 3500K, 4000K, 5000K Correlated Color Temperature (CCT)
- 90 CRI
- 10.0W - 10.4W (per CRI and CCT), 120V
- Halo matte white finish
- Torsion springs pre-installed
- Compatible with most 5" and 6" recessed housings
- Includes Edison base adapter
- Dimmable to 10% with select dimmers
- Damp and wet location listed (shower rated)
- Rated for IC, ICAT and may be used in Non-IC housings
- AIR-TITE™ certified per ASTM-E283-04
- Diffusing, regressed lens
- Five-year limited warranty

LT56 Energy Data

Max. Lumens (5000K)	754
Input Voltage	120V
Input Frequency	60 Hz
Input Power	10W - 10.4W (per CRI and CCT)
Input Current	0.085A - 0.089A (per Input power)
Power Factor	≥ 0.90
THD	≤ 24%
Sound Rating	Class A
T Ambient	-30°C (-22°F) to 40°C (104°F)



Refer to ENERGY STAR® Qualified Products List.
 Can be used to comply with California Title 24
 High Efficacy requirements.
 Certified to California Appliance Efficiency
 Database under JA8.



Ordering Information

Sample Number: **LT560WH6930**

Order Halo housing separately.

LT56 – 5"/6" LED Retrofit Baffle - Trim

LT560WH6927= 90 CRI, 2700K, Matte White

LT560WH6930= 90 CRI, 3000K, Matte White

LT560WH6935= 90 CRI, 3500K, Matte White

LT560WH6940= 90 CRI, 4000K, Matte White

LT560WH6950= 90 CRI, 5000K, Matte White

LED Housings (Order Separately)

See Housing Compatibility, Page 7

Accessories (Order Separately)

HE26LED=Replacement screw base adapter
(one included with unit)



HE26LED
Edison Base Adapter
for retrofit (included)

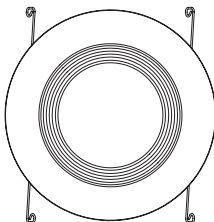
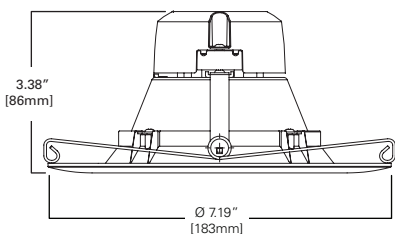

UP TO **\$350**^Δ
SAVINGS

^Δ Savings are over the life of the Halo LT56 luminaire.
Energy savings: \$300
Replacement lamp savings: \$54
Savings based on \$0.155 per kilowatt hour and 6 hours average use per day and 35,000 hours of lamp usage, 65W BR30 lumen equivalent.



LT4 Housing Compatibility

LED module is rated for installation in the following 4"

HALO®, All-Pro™ and other housings.

Halo LED	H995ICAT, H995RICAT, H245RICAT (Non-screw base, high-efficacy code compliant)
Halo	H99ICAT, H99RTAT, H99TAT, E4ICATSB, E4TATSB, E4RTATSB
All-Pro	ET400ATSB, ET400RATSB, EI400ATSB
Other Brands	The LT Series LED light module - trim combination is cULus Listed or UL Classified for use with any 4" diameter recessed housing constructed of steel or aluminum with an internal volume that exceeds 62.3 in ³ in addition to those noted above.

H995ICAT

4" LED, IC, AIR-TITE,
New Construction Housing

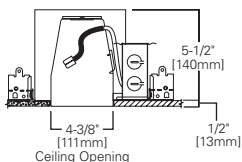

H995RICAT

4" LED, IC, AIR-TITE,
Remodel Housing

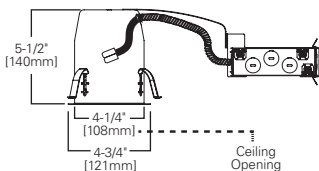

H245RICAT

4" LED, IC, AIR-TITE, Ultra Shallow Remodel Housing

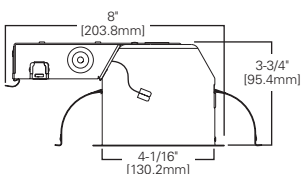

Lighting Control Solution

Eaton dimmers offer versatile options to set the mood and reduce energy consumption. These compatible LED dimmers are ideal for both residential and light commercial applications and are compatible with decorator (screwless) style devices and wallplates.

Refer to www.eaton.com for additional information.



Smart
(AAL06)



Decorator
(DAL06P)



Slide
(SAL06P)



Toggle
(TAL06P)

LT56 Housing Compatibility

LED module is rated for installation in the following 5" and 6" HALO®, All-Pro™ and other housings.

Halo 5" LED	H550ICAT, H550RICAT (Non-screw base, high-efficacy code compliant)
Halo 6" LED	H2750ICAT, H750ICAT, H750T, H750TCP, H750RICAT, H750RINTD010, H2750RICAT (Non-screw base, high-efficacy code compliant)
Halo 5"	H5T, H5TNB, H5RT, H5TM, H5ICAT, H5ICATNB, H5RICAT, H25ICAT, H25ICATNB E5ICAT, E5ICATNB, E5RICAT, E5TAT, E5TATNB, E5RTAT
Halo 6"	H7ICT, H7ICAT, H7T, H7ICATNB, H7ICTNB, H7TNB, H7UICAT, H7UICT, H7TCP, H7RICAT, H7RICT, H7RT, H27T, H27RT, H27ICAT, H27ICT, H27RICAT, H27RICT E27ICAT, E27RICAT, E27TAT, E27RTAT, E7ICAT, E7ICATNB, E7RICAT, E7TAT, E7TATNB, E7RTAT
Halo LED Retrofit	ML7BXRFK, ML7E26RFK
All-Pro 5"	EI500AT, EI500RAT, ET500, ET500R
All-Pro 6"	EI700, EI700AT, EI700ATNB, EI700U, EI700UAT, EI700NB, EI700R, EI700RAT, ET700, ET700R, EI2700, EI2700AT, EI2700R, ET2700, ET2700R
Other Brands*	The LT Series LED light module - trim combination is cULus Listed or UL Classified for use with any 5"/6" diameter recessed housing constructed of steel or aluminum with an internal volume that exceeds 107.9 in ³ in addition to those noted above.

*When using LT56 for retrofit some housings will not have torsion spring receiver brackets –use Halo ML7RAB retrofit adapter band (order separately)

H750ICAT

6" LED, IC, AIR-TITE, Standard New Construction Housing

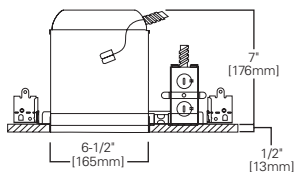

H2750ICAT

6" LED, IC, AIR-TITE, Shallow New Construction Housing

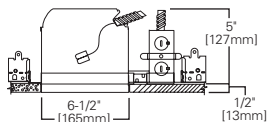

H750RICAT

6" LED, IC, AIR-TITE, Standard Remodel Housing

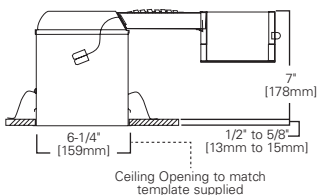

Eaton

1121 Highway 74 South
Peachtree City, GA 30269
P: 770-486-4800
www.eaton.com/lighting

Canada Sales
5925 McLaughlin Road
Mississauga, Ontario L5R 1B8
P: 905-501-3000
F: 905-501-3172

Our Lighting Product Lines

Halo
Halo Commercial
Portfolio
IRiS
RSA
Metalux
Corelite
Neo-Ray
Fail-Safe
MWS
Ametrix
Shaper
io
Lumark
McGraw-Edison
Invue
Ephesus
Lumière
Streetworks
AtLite
Sure-Lites

Our Controls Product Lines

Greengate
iLumin
Zero 88
Fifth Light Technology
iLight (International Only)

Eaton

1121 Highway 74 South
Peachtree City, GA 30269
P: 770-486-4800
www.eaton.com/lighting

© 2016 Eaton
All Rights Reserved
Printed in USA
Publication No. BR518026EN
September 2016

Products, specifications and compliances are subject to change without notice.

Eaton is a registered trademark.

All other trademarks are property of their respective owners.



Powering Business Worldwide

LED Retrofit
LT4 / LT56

HALO



EATON

Powering Business Worldwide

LT4 4" LED Retrofit Downlight



- Up to 601 lumens (5000K)
- Use to replace 60W PAR16 lamp
- 2700K, 3000K, 3500K, 4000K, 5000K Correlated Color Temperature (CCT)
- 90 CRI
- 7.5W - 8.0W (per CRI and CCT), 120V
- Halo matte white finish
- Push-N-Twist universal installation clips pre-installed
- Compatible with most 4" recessed housings
- Includes Edison base adapter
- Dimmable to 10% with select dimmers
- Damp and wet location listed (shower rated)
- Rated for IC, ICAT and may be used in Non-IC housings
- AIR-TITE™ certified per ASTM-E283-04
- Diffusing, regressed lens
- Five-year limited warranty

LT4 Energy Data

Input Voltage	120V
Input Frequency	50/60 Hz
Input Power	7.5W - 8.0W (per CRI and CCT)
Input Current	0.065A - 0.069A (per Input power)
Power Factor	>0.90
THD	≤23.5%
Sound Rating	Class A
T Ambient	-30°C (-22°F) to 40°C (104°F)



Refer to ENERGY STAR® Qualified Products List.
Can be used to comply with California Title 24
High Efficacy requirements.
Certified to California Appliance Efficiency
Database under JA8.



Ordering Information

Sample Number: **LT460WH6930**

Order Halo housing separately.

LT4 Models

LT460WH6927= 4" Retrofit Baffle - Trim LED Module, 90 CRI, 2700K, Matte White

LT460WH6930= 4" Retrofit Baffle - Trim LED Module, 90 CRI, 3000K, Matte White

LT460WH6935= 4" Retrofit Baffle - Trim LED Module, 90 CRI, 3500K, Matte White

LT460WH6940= 4" Retrofit Baffle - Trim LED Module, 90 CRI, 4000K, Matte White

LT460WH6950= 4" Retrofit Baffle - Trim LED Module, 90 CRI, 5000K, Matte White

LED Housings (Order Separately)

See Housing Compatibility, Page 6

Accessories (Order Separately)

HE26LED=Replacement screw base adapter
(one included with unit)

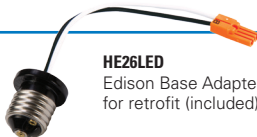

HE26LED
Edison Base Adapter
for retrofit (included)

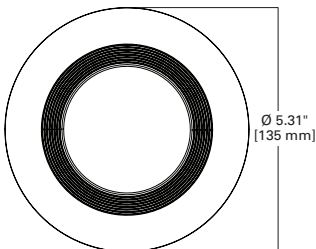
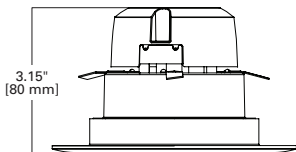

UP TO **\$373**^Δ
SAVINGS

^Δ Savings are over the life of the Halo LT4 luminaire.

Energy savings: \$283

Replacement lamp savings: \$90

Savings based on \$0.155 per kilowatt hour, average 6 hours use per day, 35,000 hours of lamp usage, and 60W PAR16 Halogen lamp lumen equivalent.



LT56 5" / 6" LED Retrofit Downlight



- Up to 772 lumens (5000K)
- Use to replace 65W BR30 or 50W PAR30 lamp
- 2700K, 3000K, 3500K, 4000K, 5000K Correlated Color Temperature (CCT)
- 90 CRI
- 10.0W - 10.4W (per CRI and CCT), 120V
- Halo matte white finish
- Torsion springs pre-installed
- Compatible with most 5" and 6" recessed housings
- Includes Edison base adapter
- Dimmable to 10% with select dimmers
- Damp and wet location listed (shower rated)
- Rated for IC, ICAT and may be used in Non-IC housings
- AIR-TITE™ certified per ASTM-E283-04
- Diffusing, regressed lens
- Five-year limited warranty

LT56 Energy Data

Max. Lumens (5000K)	754
Input Voltage	120V
Input Frequency	60 Hz
Input Power	10W - 10.4W (per CRI and CCT)
Input Current	0.085A - 0.089A (per Input power)
Power Factor	≥ 0.90
THD	≤ 24%
Sound Rating	Class A
T Ambient	-30°C (-22°F) to 40°C (104°F)



Refer to ENERGY STAR® Qualified Products List.
Can be used to comply with California Title 24
High Efficacy requirements.
Certified to California Appliance Efficiency
Database under JA8.



Ordering Information

Sample Number: **LT560WH6930**

Order Halo housing separately.

LT56 – 5"/6" LED Retrofit Baffle - Trim

LT560WH6927= 90 CRI, 2700K, Matte White

LT560WH6930= 90 CRI, 3000K, Matte White

LT560WH6935= 90 CRI, 3500K, Matte White

LT560WH6940= 90 CRI, 4000K, Matte White

LT560WH6950= 90 CRI, 5000K, Matte White

LED Housings (Order Separately)

See Housing Compatibility, Page 7

Accessories (Order Separately)

HE26LED=Replacement screw base adapter
(one included with unit)



HE26LED
Edison Base Adapter
for retrofit (included)

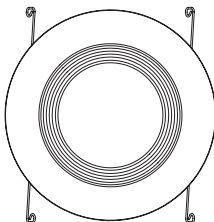
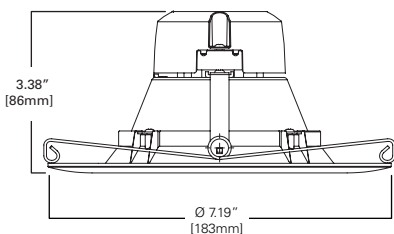

UP TO **\$350**^Δ
SAVINGS

^Δ Savings are over the life of the Halo LT56 luminaire.
Energy savings: \$300
Replacement lamp savings: \$54
Savings based on \$0.155 per kilowatt hour and 6 hours average use per day and 35,000 hours of lamp usage, 65W BR30 lumen equivalent.



LT4 Housing Compatibility

LED module is rated for installation in the following 4"

HALO®, All-Pro™ and other housings.

Halo LED	H995ICAT, H995RICAT, H245RICAT (Non-screw base, high-efficacy code compliant)
Halo	H99ICAT, H99RTAT, H99TAT, E4ICATSB, E4TATSB, E4RTATSB
All-Pro	ET400ATSB, ET400RATSB, EI400ATSB
Other Brands	The LT Series LED light module - trim combination is cULus Listed or UL Classified for use with any 4" diameter recessed housing constructed of steel or aluminum with an internal volume that exceeds 62.3 in ³ in addition to those noted above.

H995ICAT

4" LED, IC, AIR-TITE,
New Construction Housing

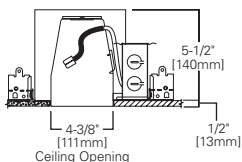

H995RICAT

4" LED, IC, AIR-TITE,
Remodel Housing

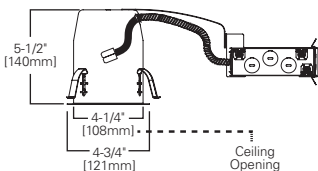

H245RICAT

4" LED, IC, AIR-TITE, Ultra Shallow Remodel Housing

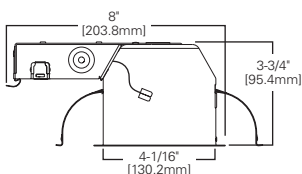

Lighting Control Solution

Eaton dimmers offer versatile options to set the mood and reduce energy consumption. These compatible LED dimmers are ideal for both residential and light commercial applications and are compatible with decorator (screwless) style devices and wallplates.

Refer to www.eaton.com for additional information.



Smart
(AAL06)



Decorator
(DAL06P)



Slide
(SAL06P)



Toggle
(TAL06P)

LT56 Housing Compatibility

LED module is rated for installation in the following 5" and 6" HALO®, All-Pro™ and other housings.

Halo 5" LED	H550ICAT, H550RICAT (Non-screw base, high-efficacy code compliant)
Halo 6" LED	H2750ICAT, H750ICAT, H750T, H750TCP, H750RICAT, H750RINTD010, H2750RICAT (Non-screw base, high-efficacy code compliant)
Halo 5"	H5T, H5TNB, H5RT, H5TM, H5ICAT, H5ICATNB, H5RICAT, H25ICAT, H25ICATNB E5ICAT, E5ICATNB, E5RICAT, E5TAT, E5TATNB, E5RTAT
Halo 6"	H7ICT, H7ICAT, H7T, H7ICATNB, H7ICTNB, H7TNB, H7UICAT, H7UICT, H7TCP, H7RICAT, H7RICT, H7RT, H27T, H27RT, H27ICAT, H27ICT, H27RICAT, H27RICT E27ICAT, E27RICAT, E27TAT, E27RTAT, E7ICAT, E7ICATNB, E7RICAT, E7TAT, E7TATNB, E7RTAT
Halo LED Retrofit	ML7BXRFK, ML7E26RFK
All-Pro 5"	EI500AT, EI500RAT, ET500, ET500R
All-Pro 6"	EI700, EI700AT, EI700ATNB, EI700U, EI700UAT, EI700NB, EI700R, EI700RAT, ET700, ET700R, EI2700, EI2700AT, EI2700R, ET2700, ET2700R
Other Brands*	The LT Series LED light module - trim combination is cULus Listed or UL Classified for use with any 5"/6" diameter recessed housing constructed of steel or aluminum with an internal volume that exceeds 107.9 in ³ in addition to those noted above.

*When using LT56 for retrofit some housings will not have torsion spring receiver brackets –use Halo ML7RAB retrofit adapter band (order separately)

H750ICAT

6" LED, IC, AIR-TITE, Standard New Construction Housing

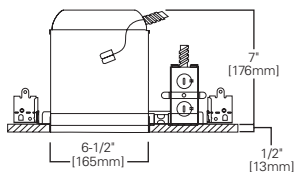

H2750ICAT

6" LED, IC, AIR-TITE, Shallow New Construction Housing

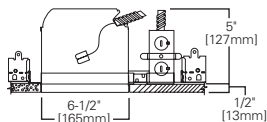

H750RICAT

6" LED, IC, AIR-TITE, Standard Remodel Housing

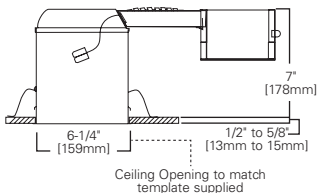

Eaton

1121 Highway 74 South
Peachtree City, GA 30269
P: 770-486-4800
www.eaton.com/lighting

Canada Sales
5925 McLaughlin Road
Mississauga, Ontario L5R 1B8
P: 905-501-3000
F: 905-501-3172

Our Lighting Product Lines

Halo
Halo Commercial
Portfolio
IRiS
RSA
Metalux
Corelite
Neo-Ray
Fail-Safe
MWS
Ametrix
Shaper
io
Lumark
McGraw-Edison
Invue
Ephesus
Lumière
Streetworks
AtLite
Sure-Lites

Our Controls Product Lines

Greengate
iLumin
Zero 88
Fifth Light Technology
iLight (International Only)

Eaton

1121 Highway 74 South
Peachtree City, GA 30269
P: 770-486-4800
www.eaton.com/lighting

© 2016 Eaton
All Rights Reserved
Printed in USA
Publication No. BR518026EN
September 2016

Products, specifications and compliances are subject to change without notice.

Eaton is a registered trademark.

All other trademarks are property of their respective owners.



Powering Business Worldwide