

CONNECTORS

Compression Connectors

Long Barrel One Hole Copper Lugs

L Series Cont'd



FEATURES

- Produced from high conductivity copper tubing.
- Tin-plated to provide corrosion low contact resistance.
- Marked with die index and color coded.
- Listed for 35KV max when properly installed and to cable manufacturer instructions.
- For applications greater than 2000V, consult the cable Manufacturer for voltage stress relief instructions.
- **Part Numbers ending in "P" have a "peep" or sight inspection hole.**

SPECIFICATIONS

- UL486A Listed Wire Connector.
- UL467 Grounding & Bonding (Sizes 8 AWG - 3/0 AWG).
- Max ampacity is based on NEC 310.15, insulation type, and conductor material. Please consult your current NEC manual..
- * CLASS B OR C BUILDING WIRE CU CABLE ONLY.
- Temperature Rating: 90 °C.
- Voltage: 600V

CONNECTORS

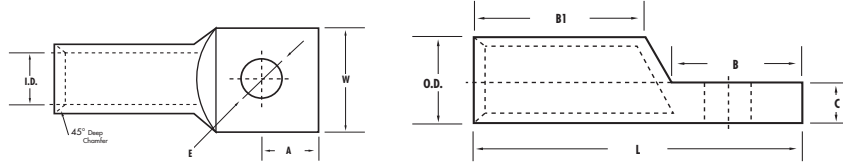

***EXPANDED WIRE RANGE** when installed with NSI N12ID dieless compression tool.
 UL Listed with other tools:
FOR TOOL/DIE CRIMPING INFORMATION, PLEASE SEE TABLE ON PAGE 87

CAT. NO.	WIRE RANGE	EXPANDED WIRE RANGE**	BOLT SIZE (IN.)	BARREL I.D.	BARREL O.D.	LENGTH (L) (IN.)	WIDTH (W) (IN.)	A (IN.)	B (IN.)	B1 (IN.)	C (IN.)	E (IN.)	COLOR	STD. CTN. QTY.
L356	3 AWG	3 - 6 AWG	5/16"	0.270	0.377	2.157	0.538	0.346	0.767	1.120	0.091	0.336	White	50
L338	3 AWG	3 - 6 AWG	3/8"	0.270	0.377	2.351	0.550	0.418	0.823	1.188	0.083	0.397	White	50
L214	2 AWG	2 - 6 AWG	1/4"	0.315	0.421	2.071	0.602	0.206	0.811	1.102	0.102	0.252	Brown	50
L214P	2 AWG	2 - 6 AWG	1/4"	0.315	0.421	2.071	0.602	0.206	0.811	1.102	0.102	0.252	Brown	50
L256	2 AWG	2 - 6 AWG	5/16"	0.315	0.421	2.071	0.602	0.370	0.811	1.102	0.102	0.331	Brown	50
L256P	2 AWG	2 - 6 AWG	5/16"	0.315	0.421	2.071	0.602	0.370	0.811	1.102	0.102	0.331	Brown	50
L238	2 AWG	2 - 6 AWG	3/8"	0.315	0.421	2.071	0.602	0.370	0.811	1.102	0.102	0.413	Brown	50
L238P	2 AWG	2 - 6 AWG	3/8"	0.315	0.421	2.071	0.602	0.370	0.811	1.102	0.102	0.413	Brown	50
L156	1 AWG	1 - 6 AWG	5/16"	0.358	0.469	2.110	0.673	0.370	0.811	1.102	0.106	0.331	Green	50
L138	1 AWG	1 - 6 AWG	3/8"	0.358	0.469	2.209	0.673	0.370	0.811	1.102	0.106	0.413	Green	50
L1014	1/0 AWG	1/0 - 6 AWG	1/4"	0.390	0.520	2.210	0.744	0.370	0.811	1.201	0.126	0.210	Pink	50
L1014P	1/0 AWG	1/0 - 6 AWG	1/4"	0.390	0.520	2.210	0.744	0.370	0.811	1.201	0.126	0.210	Pink	50
L1038	1/0 AWG	1/0 - 6 AWG	3/8"	0.390	0.520	2.209	0.744	0.370	0.811	1.201	0.126	0.413	Pink	50
L1038P	1/0 AWG	1/0 - 6 AWG	3/8"	0.390	0.520	2.209	0.744	0.370	0.811	1.201	0.126	0.413	Pink	50
L1056	1/0 AWG	1/0 - 6 AWG	5/16"	0.390	0.520	2.210	0.744	0.370	0.811	1.201	0.126	0.330	Pink	50
L1056P	1/0 AWG	1/0 - 6 AWG	5/16"	0.390	0.520	2.210	0.744	0.370	0.811	1.201	0.126	0.330	Pink	50
L1048	1/0 AWG	1/0 - 6 AWG	1/2"	0.390	0.520	2.500	0.744	0.472	1.063	1.201	0.126	0.512	Pink	50
L2014	2/0 AWG	2/0 - 4 AWG	1/4"	0.441	0.563	2.677	0.815	0.472	1.063	1.378	0.118	0.252	Black	25
L2014P	2/0 AWG	2/0 - 4 AWG	1/4"	0.441	0.563	2.677	0.815	0.472	1.063	1.378	0.118	0.252	Black	25
L2038	2/0 AWG	2/0 - 4 AWG	3/8"	0.441	0.563	2.677	0.815	0.472	1.063	1.378	0.118	0.413	Black	25
L2038P	2/0 AWG	2/0 - 4 AWG	3/8"	0.441	0.563	2.677	0.815	0.472	1.063	1.378	0.118	0.413	Black	25
L2048	2/0 AWG	2/0 - 4 AWG	1/2"	0.441	0.563	2.677	0.815	0.472	1.063	1.378	0.118	0.512	Black	25

CONNECTORS

Compression Connectors

Long Barrel One Hole Copper Lugs L Series Cont'd



FEATURES

- Produced from high conductivity copper tubing.
- Tin-plated to provide corrosion low contact resistance.
- Marked with die index and color coded.
- Listed for 35KV max when properly installed and to cable manufacturer instructions.
- For applications greater than 2000V, consult the cable Manufacturer for voltage stress relief instructions.
- **Part Numbers ending in "P" have a "peep" or sight inspection hole.**

SPECIFICATIONS

- UL486A Listed Wire Connector.
- UL467 Grounding & Bonding (Sizes 8 AWG - 3/0 AWG).
- Max ampacity is based on NEC 310.15, insulation type, and conductor material. Please consult your current NEC manual.
- * CLASS B OR C BUILDING WIRE CU CABLE ONLY.
- Temperature Rating: 90 °C.
- Voltage: 600V

CONNECTORS

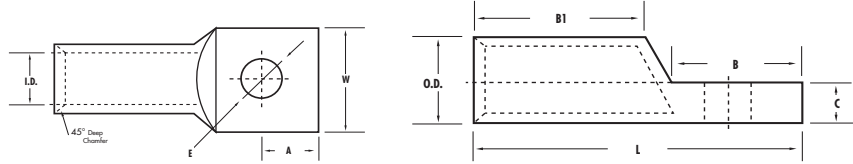

***EXPANDED WIRE RANGE** when installed with NSI N12ID dieless compression tool.
UL Listed with other tools:
FOR TOOL/DIE CRIMPING INFORMATION, PLEASE SEE TABLE ON PAGE 87

CAT. NO.	WIRE RANGE	EXPANDED WIRE RANGE**	BOLT SIZE (IN.)	BARREL I.D.	BARREL O.D.	LENGTH (L) (IN.)	WIDTH (W) (IN.)	A (IN.)	B (IN.)	B1 (IN.)	C (IN.)	E (IN.)	COLOR	STD. CTN. QTY.
L356	3 AWG	3 - 6 AWG	5/16"	0.270	0.377	2.157	0.538	0.346	0.767	1.120	0.091	0.336	White	50
L338	3 AWG	3 - 6 AWG	3/8"	0.270	0.377	2.351	0.550	0.418	0.823	1.188	0.083	0.397	White	50
L214	2 AWG	2 - 6 AWG	1/4"	0.315	0.421	2.071	0.602	0.206	0.811	1.102	0.102	0.252	Brown	50
L214P	2 AWG	2 - 6 AWG	1/4"	0.315	0.421	2.071	0.602	0.206	0.811	1.102	0.102	0.252	Brown	50
L256	2 AWG	2 - 6 AWG	5/16"	0.315	0.421	2.071	0.602	0.370	0.811	1.102	0.102	0.331	Brown	50
L256P	2 AWG	2 - 6 AWG	5/16"	0.315	0.421	2.071	0.602	0.370	0.811	1.102	0.102	0.331	Brown	50
L238	2 AWG	2 - 6 AWG	3/8"	0.315	0.421	2.071	0.602	0.370	0.811	1.102	0.102	0.413	Brown	50
L238P	2 AWG	2 - 6 AWG	3/8"	0.315	0.421	2.071	0.602	0.370	0.811	1.102	0.102	0.413	Brown	50
L156	1 AWG	1 - 6 AWG	5/16"	0.358	0.469	2.110	0.673	0.370	0.811	1.102	0.106	0.331	Green	50
L138	1 AWG	1 - 6 AWG	3/8"	0.358	0.469	2.209	0.673	0.370	0.811	1.102	0.106	0.413	Green	50
L1014	1/0 AWG	1/0 - 6 AWG	1/4"	0.390	0.520	2.210	0.744	0.370	0.811	1.201	0.126	0.210	Pink	50
L1014P	1/0 AWG	1/0 - 6 AWG	1/4"	0.390	0.520	2.210	0.744	0.370	0.811	1.201	0.126	0.210	Pink	50
L1038	1/0 AWG	1/0 - 6 AWG	3/8"	0.390	0.520	2.209	0.744	0.370	0.811	1.201	0.126	0.413	Pink	50
L1038P	1/0 AWG	1/0 - 6 AWG	3/8"	0.390	0.520	2.209	0.744	0.370	0.811	1.201	0.126	0.413	Pink	50
L1056	1/0 AWG	1/0 - 6 AWG	5/16"	0.390	0.520	2.210	0.744	0.370	0.811	1.201	0.126	0.330	Pink	50
L1056P	1/0 AWG	1/0 - 6 AWG	5/16"	0.390	0.520	2.210	0.744	0.370	0.811	1.201	0.126	0.330	Pink	50
L1048	1/0 AWG	1/0 - 6 AWG	1/2"	0.390	0.520	2.500	0.744	0.472	1.063	1.201	0.126	0.512	Pink	50
L2014	2/0 AWG	2/0 - 4 AWG	1/4"	0.441	0.563	2.677	0.815	0.472	1.063	1.378	0.118	0.252	Black	25
L2014P	2/0 AWG	2/0 - 4 AWG	1/4"	0.441	0.563	2.677	0.815	0.472	1.063	1.378	0.118	0.252	Black	25
L2038	2/0 AWG	2/0 - 4 AWG	3/8"	0.441	0.563	2.677	0.815	0.472	1.063	1.378	0.118	0.413	Black	25
L2038P	2/0 AWG	2/0 - 4 AWG	3/8"	0.441	0.563	2.677	0.815	0.472	1.063	1.378	0.118	0.413	Black	25
L2048	2/0 AWG	2/0 - 4 AWG	1/2"	0.441	0.563	2.677	0.815	0.472	1.063	1.378	0.118	0.512	Black	25