

# C2-A2x

2 pole | changeover contact | plug-in

<b>Maximum contact load</b>	<b>10 A/250 V AC-1</b>	<b>0.5 A/110 V DC-1</b>
	<b>10 A/30 V DC-1</b>	<b>0.2 A/220 V DC-1</b>
<b>Recommended minimum contact load</b>	<b>10 mA/10 V Code 0</b>	
	<b>5 mA/5 V Code 8</b>	

### Contacts

Material	Standard	Code 0	AgNi
	Optional	Code 8	AgNi + 5 μ Au
Max. switching current	10 A		
Max. peak inrush current (20 ms.)	30 A		
Max. switching voltage	250 V		
Max. AC load (Fig 1 1)	2.5 kVA		
Max. DC load	See Fig 2		

### Coils

Coil resistance	see table; tolerance ± 10 %
Pick up voltage	≤ 0.8 × U <sub>N</sub>
Pick up voltage	≥ 0.1 × U <sub>N</sub>
Nominal power	2.2 VA (AC)/1.3 W (DC)

### Table

V AC	Ω	mA	VDC	Ω	mA
24	67	92	24	443	54
48	296	46	48	1K8	27
115	1K7	19	110	9K	12
230	7K1	9.5	220	36K1	6

### Insulation

	Volt rms / 1 min
Open contact	1000 V
Between adjacent poles	2.5 kV
Between contacts and coil	2.5 kV
Insulation resistance at 500 V	≥ 1 GΩ
Insulation, IEC 61810-1	2.5 kV

### Specifications

Ambient temperature operation/storage	-40...60 °C / -40 ... 80 °C (no ice)
Pick-up time + bounce time	16 ms/≤ 3 ms
Release time + bounce time	8 ms/≤ 1 ms
Mechanical life ops	AC: 10 Mill./DC: 20 Mill.
DC voltage endurance at rated load	≥ 100 000 ops. switching cycles
Operating frequency at nominal load	≤ 1200/ops/h
Weight	79 g

### Product References

V AC 50 Hz/60 Hz: 24, 48, 115 (120), 230 (240)

LED

RC Suppressor

VDC 24, 48, 110, 220

LED

Free wheeling diode

Polarity and free wheeling diode

AC/DC bridge rectifier 24 V, 48 V, 60 V

Other voltages on request

C2-A20/AC ... V	C2-A28/AC ... V
C2-A20X/AC ... V	C2-A28X/AC ... V
C2-A20R/AC ... V	C2-A28R/AC ... V
C2-A20/DC ... V	C2-A28/DC ... V
C2-A20X/DC ... V	C2-A28X/DC ... V
C2-A20DX/DC ... V	C2-A28DX/DC ... V
C2-A20FX/DC ... V	C2-A28FX/DC ... V
C2-A20BX/UC ... V	C2-A28BX/UC ... V

"..." List Coil Voltage to complete Product References

### Accessories (See also Section Sockets)

Socket:	<b>S2-B, S2-PO</b>
Blanking Plug:	<b>SO-NP (BAG 10 PCS)</b>

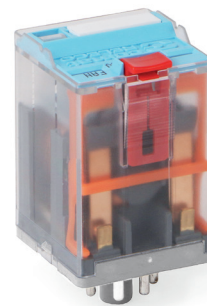

### Connection diagram

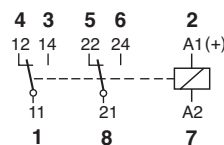

Fig.1 AC voltage endurance

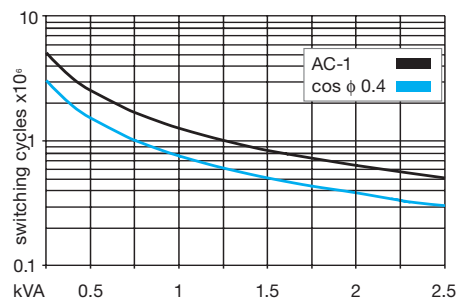
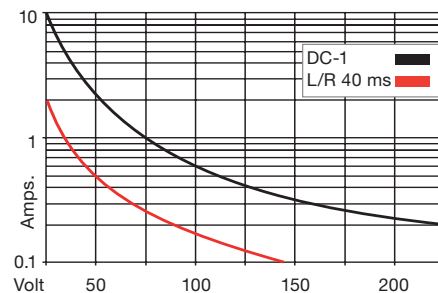
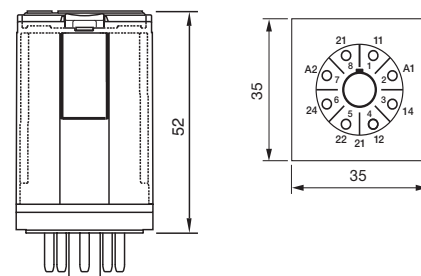

Fig. 2 DC load limit curve



### Dimensions



### Technical approvals, conformities



# C2-A2x

2 pole | changeover contact | plug-in

<b>Maximum contact load</b>	<b>10 A/250 V AC-1</b>	<b>0.5 A/110 V DC-1</b>
	<b>10 A/30 V DC-1</b>	<b>0.2 A/220 V DC-1</b>
<b>Recommended minimum contact load</b>	<b>10 mA/10 V Code 0</b>	
	<b>5 mA/5 V Code 8</b>	

### Contacts

Material	Standard	Code 0	AgNi
	Optional	Code 8	AgNi + 5 μ Au
Max. switching current	10 A		
Max. peak inrush current (20 ms.)	30 A		
Max. switching voltage	250 V		
Max. AC load (Fig 1 1)	2.5 kVA		
Max. DC load	See Fig 2		

### Coils

Coil resistance	see table; tolerance ± 10 %
Pick up voltage	≤ 0.8 × U <sub>N</sub>
Pick up voltage	≥ 0.1 × U <sub>N</sub>
Nominal power	2.2 VA (AC)/1.3 W (DC)

### Table

V AC	Ω	mA	VDC	Ω	mA
24	67	92	24	443	54
48	296	46	48	1K8	27
115	1K7	19	110	9K	12
230	7K1	9.5	220	36K1	6

### Insulation

	Volt rms / 1 min
Open contact	1000 V
Between adjacent poles	2.5 kV
Between contacts and coil	2.5 kV
Insulation resistance at 500 V	≥ 1 GΩ
Insulation, IEC 61810-1	2.5 kV

### Specifications

Ambient temperature operation/storage	-40...60 °C / -40 ... 80 °C (no ice)
Pick-up time + bounce time	16 ms/≤ 3 ms
Release time + bounce time	8 ms/≤ 1 ms
Mechanical life ops	AC: 10 Mill./DC: 20 Mill.
DC voltage endurance at rated load	≥ 100 000 ops. switching cycles
Operating frequency at nominal load	≤ 1200/ops/h
Weight	79 g

### Product References

V AC 50 Hz/60 Hz: 24, 48, 115 (120), 230 (240)

LED

RC Suppressor

VDC 24, 48, 110, 220

LED

Free wheeling diode

Polarity and free wheeling diode

AC/DC bridge rectifier 24 V, 48 V, 60 V

Other voltages on request

C2-A20/AC ... V	C2-A28/AC ... V
C2-A20X/AC ... V	C2-A28X/AC ... V
C2-A20R/AC ... V	C2-A28R/AC ... V
C2-A20/DC ... V	C2-A28/DC ... V
C2-A20X/DC ... V	C2-A28X/DC ... V
C2-A20DX/DC ... V	C2-A28DX/DC ... V
C2-A20FX/DC ... V	C2-A28FX/DC ... V
C2-A20BX/UC ... V	C2-A28BX/UC ... V

"..." List Coil Voltage to complete Product References

### Accessories (See also Section Sockets)

Socket:	<b>S2-B, S2-PO</b>
Blanking Plug:	<b>SO-NP (BAG 10 PCS)</b>

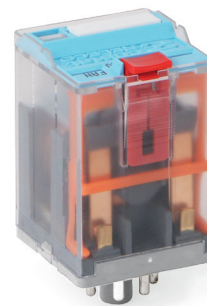

### Connection diagram

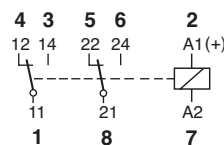

### Fig.1 AC voltage endurance

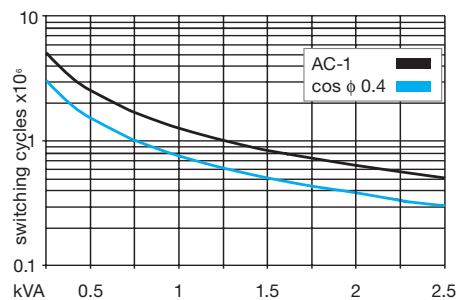

### Fig. 2 DC load limit curve

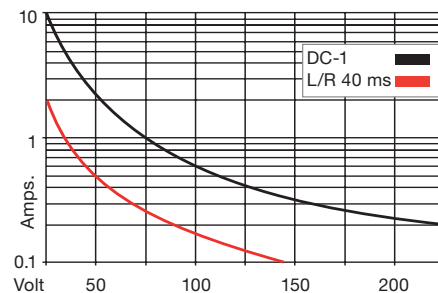

### Dimensions

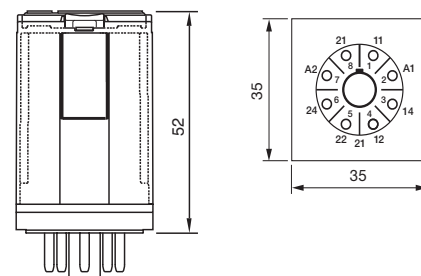

### Technical approvals, conformities

