



Core & Coil (71A) HPS 200W - 400W

CORE & COIL HID 71A8271001D

The basic ballast is the open core and coil which is most often used as a component within a lighting luminaire. The core and coil also forms the nucleus of Philips Advance's five other ballast configurations.

Product data

| General Information | | Input Frequency | |
|------------------------------------|-------------------|---|---|
| ANSI Code | S50 | Input Frequency | 60 Hz |
| Lamp Type | 250W HPS | Input Current (Open Circuit) | 1.53/0.95/0.77/0.63 A |
| Number of Lamps | 1 piece/unit | Input Current (Starting) | 1.61/0.89/0.8/0.68 A |
| Circuit Type | CWA | Input Current (Short Circuit) | 1.16-1.74/0.64-0.96/0.56-0.85/0.49-0.74 A |
| Ballast Type | Magnetic HID | Secondary Short Circuit Current | 3.65-4.45 A |
| Base Model | 71A8271 | Constant Wattage Deviation | Within Trapezoid |
| Core Size | 4 x 4 (2 coil) | Ballast Factor (Nom) | 1 |
| Suitable For Outdoor Use | Yes | Power Factor (Nom) | 0.90 |
| Ignitor Catalog Number | LI501-H4 | Open Circuit Voltage | 187 V |
| Ignitor Temperature Rating | 105°C | Input Current (Nom) | 2.5/1.47/1.25/1.09 A A |
| Capacitor Value | 35 MFD | Input Power (Nom) | 295 W |
| Capacitor Catalog Number | 7C350P24RA | Rated Lamp Power | 250 W |
| Capacitor Requirements | 240V | Wiring | |
| Capacitor Temperature Rating | 105°C | Wire Striplength | 0.5 mm |
| Capacitor Diameter/Oval Dimensions | 1.65 in | Wire Length by Color | 12" |
| Capacitor Height | 3.7 in | Wire Type | Stranded |
| Automatic Restart | No | Remote Wiring Configuration Allowed | Yes |
| Operating and Electrical | | Max Ballast-Lamp Distance Remote Wiring | 2' |
| Input Voltage | 120/208/240/277 V | Recommended Fuse Value | 7/4/4/3 A |

Core & Coil (71A) HPS 200W - 400W

Approval and Application

| | |
|-----------------------------------|------------------------------------|
| Open Circuit Voltage Test (Volts) | 170-205 V |
| Approval Marks | ULR CSA certificate RoHS Compliant |
| Temperature Marking | B/B/B/B |
| UL Recognized | Yes |
| Hipot Test (1 Minute) | 2000 V |
| Hipot Test (2 Seconds) | 2500 V |
| UL Insulation Class | H(180°C) |
| UL Temperature Code | 1029B |

Product Data

| | |
|---------------------------------|-----------------------------|
| Order product name | CORE & COIL HID 71A8271001D |
| EAN/UPC - Product | 781087827116 |
| Order code | 913700556609 |
| Numerator - Quantity Per Pack | 1 |
| Numerator - Packs per outer box | 1 |
| Material Nr. (12NC) | 913700556609 |
| Net Weight (Piece) | 5.176 kg |

Dimensional drawing

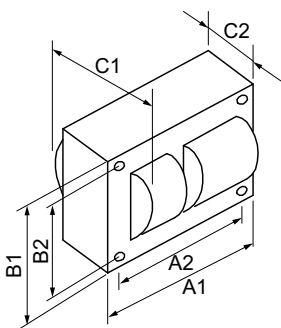

HPS BAL 250W S50 QUAD C&C

| Product | C1 | C2 | A1 | A2 | B1 | B2 |
|-----------------------------|---------|--------|--------|--------|--------|--------|
| CORE & COIL HID 71A8271001D | 3.82 in | 1.8 in | 4.8 in | 4.4 in | 4.3 in | 3.9 in |





Core & Coil (71A) HPS 200W - 400W

CORE & COIL HID 71A8271001D

The basic ballast is the open core and coil which is most often used as a component within a lighting luminaire. The core and coil also forms the nucleus of Philips Advance's five other ballast configurations.

Product data

| General Information | |
|------------------------------------|-------------------|
| ANSI Code | S50 |
| Lamp Type | 250W HPS |
| Number of Lamps | 1 piece/unit |
| Circuit Type | CWA |
| Ballast Type | Magnetic HID |
| Base Model | 71A8271 |
| Core Size | 4 x 4 (2 coil) |
| Suitable For Outdoor Use | Yes |
| Ignitor Catalog Number | LI501-H4 |
| Ignitor Temperature Rating | 105°C |
| Capacitor Value | 35 MFD |
| Capacitor Catalog Number | 7C350P24RA |
| Capacitor Requirements | 240V |
| Capacitor Temperature Rating | 105°C |
| Capacitor Diameter/Oval Dimensions | 1.65 in |
| Capacitor Height | 3.7 in |
| Automatic Restart | No |
| Operating and Electrical | |
| Input Voltage | 120/208/240/277 V |

| Input Frequency | 60 Hz |
|---|---|
| Input Current (Open Circuit) | 1.53/0.95/0.77/0.63 A |
| Input Current (Starting) | 1.61/0.89/0.8/0.68 A |
| Input Current (Short Circuit) | 1.16-1.74/0.64-0.96/0.56-0.85/0.49-0.74 A |
| Secondary Short Circuit Current | 3.65-4.45 A |
| Constant Wattage Deviation | Within Trapezoid |
| Ballast Factor (Nom) | 1 |
| Power Factor (Nom) | 0.90 |
| Open Circuit Voltage | 187 V |
| Input Current (Nom) | 2.5/1.47/1.25/1.09 A A |
| Input Power (Nom) | 295 W |
| Rated Lamp Power | 250 W |
| Wiring | |
| Wire Striplength | 0.5 mm |
| Wire Length by Color | 12" |
| Wire Type | Stranded |
| Remote Wiring Configuration Allowed | Yes |
| Max Ballast-Lamp Distance Remote Wiring | 2' |
| Recommended Fuse Value | 7/4/4/3 A |

Core & Coil (71A) HPS 200W - 400W

Approval and Application

| | |
|-----------------------------------|------------------------------------|
| Open Circuit Voltage Test (Volts) | 170-205 V |
| Approval Marks | ULR CSA certificate RoHS Compliant |
| Temperature Marking | B/B/B/B |
| UL Recognized | Yes |
| Hipot Test (1 Minute) | 2000 V |
| Hipot Test (2 Seconds) | 2500 V |
| UL Insulation Class | H(180°C) |
| UL Temperature Code | 1029B |

Product Data

| | |
|---------------------------------|-----------------------------|
| Order product name | CORE & COIL HID 71A8271001D |
| EAN/UPC - Product | 781087827116 |
| Order code | 913700556609 |
| Numerator - Quantity Per Pack | 1 |
| Numerator - Packs per outer box | 1 |
| Material Nr. (12NC) | 913700556609 |
| Net Weight (Piece) | 5.176 kg |

Dimensional drawing



HPS BAL 250W S50 QUAD C&C

| Product | C1 | C2 | A1 | A2 | B1 | B2 |
|-----------------------------|---------|--------|--------|--------|--------|--------|
| CORE & COIL HID 71A8271001D | 3.82 in | 1.8 in | 4.8 in | 4.4 in | 4.3 in | 3.9 in |

