

Cable and Bolt Cutters

Klein exceeds the highest standards to create superior cable and bolt cutters, offering greater cutting power, clean and precise cuts, as well as long life. Klein cable and bolt cutters are a cut above the rest.



For Professionals...
Since 1857™



Plastic-dipped handles for comfort and ease of identification

FORGED STEEL
from Klein's US-made, proprietary blend

Cable Cutters

Hot-riveted joint ensures smooth action and no handle wobble

Through-hardened (not case-hardened) for longer-lasting cutting surfaces

Beveled jaw tips provide proper mating and shearing action, which protects leading jaw edges



High-Leverage Cable Cutters

Includes core cable cutter features plus:

- High-leverage design for exceptional cutting capability
- Precision, one-hand shearing action
- Cable-gripping shear-type jaws
- Perfect for working in confined spaces
- Fits in most tool pouches/belts



63050



Plastic-Dipped

JOURNEYMAN™
Dual-Material

Refer to the insulated section for insulated cable cutters.

Cat. No.	Cutting Capacity	Handle Color	Handle Finish	Overall Length	Weight
63050	4/0 Aluminum, 2/0 Soft Copper, 100-Pair 24 AWG Communications Cable	Red	Plastic-dipped	9-1/2" (241.3 mm)	0.90 lb (0.41 kg)
J63050	4/0 Aluminum, 2/0 Soft Copper, 100-Pair 24 AWG Communications Cable	Red/Black	Journeyman	9-9/16" (242.9 mm)	0.98 lb (0.44 kg)

Cable Cutters - Coaxial

Includes core cable cutter features plus:

- Cable-gripping jaws quickly score jacket and insulation, and easily cut through copper inner conductor
- Blades cleanly cut aluminum and copper coaxial cable without compression and frayed ends
- Forged body with heat-treated and precision-ground steel blade withstands frequent cutting
- Hot-riveted design requires no adjustment while maintaining a smooth, precise operation
- Compact, lightweight design fits perfectly in any professional's tool pouch
- When cutting drop wire with an inner steel conductor, we recommend our 2000 Series cutting pliers



63028



63030

Cat. No.	Cutting Capacity	Handle Color	Handle Finish	Overall Length	Weight
63028	3/4" (19.1 mm)	Yellow	Plastic-dipped	8-1/4" (209.6 mm)	0.80 lb (0.36 kg)
63030	1" (25.4 mm)	Blue	Plastic-dipped	8-1/4" (209.6 mm)	0.83 lb (0.38 kg)

See page 295 for additional information on warnings.



WARNING: Do NOT cut steel or ACSR.

Cable Cutters

Compact Cable Cutter

Includes core cable cutter features plus:

- Precise, one-hand shearing action cuts 24 AWG copper, aluminum multi-strand cable and wire, and 100-pair telephone cable
- Special shear angle cuts cleanly without compression to cable geometry for telecom cable work
- Heat-treated, high-carbon steel shearing edges for long life
- Forged body with 3/8" (10 mm) case-hardened rivet



63055

⚠WARNING: Do NOT cut steel or ACSR.

Cat. No.	Cutting Capacity	Handle Color	Handle Finish	Overall Length	Weight
63055	24 AWG Copper, Aluminum Multi-Strand Cable and Wire, and 100-Pair Telephone Cable	Red	Plastic-dipped	8" (203.2 mm)	0.65 lb (0.29 kg)

All-Purpose Shears and BX Cutter

Includes core cable cutter features plus:

- Handle cavity is designed to restore BX cable to original shape after cutting
- Stripping notch for added convenience
- High-leverage, shear-type design for one-hand operation
- Lightweight and compact



1104

⚠WARNING: Do NOT cut steel or ACSR.

Cat. No.	Cutting Capacity	Handle Color	Handle Finish	Overall Length	Weight
1104	Cuts BX Cable, Sheet Metal, Steel Strapping and Bundling Wire	Red	Plastic Dipped	7-5/8" (193.7 mm)	0.60 lb (0.27 kg)

Heavy-Duty Cable Shears

- Cuts ACSR, steel, and most hardened wire
- Heavy-duty, tempered steel blades
- Blades grip cable and cut easily at center of jaws
- Lock keeps handles closed for easy storage
- Comfortable, plastic-coated handles for steady grip
- Hardened steel, precision cutting blades for long service life
- Unique triangular jaws cleanly cut cable without compression or frayed ends



63016

Cat. No.	Cutting Capacity	Handle Color	Handle Finish	Overall Length	Weight
63016	Up to 1/4" (6.4 mm) Copper and Mild Steel Strands, up to 3/16" (4.8 mm) Aircraft Cable, Wire Rope, Aluminum and Copper Rods, up to 5/32" (4 mm) for Steel and Iron Rods	Blue	Plastic-dipped	7-1/2" (190.5 mm)	0.65 lb (0.29 kg)

Multi-Cable Cutter

- Hardened steel precision-ground cutting blades for long life
- Copper curved cutter cleanly cuts round copper cable without compression or frayed ends
- Double-dipped grips for comfort
- Coil spring provides fast self-opening action
- Holes for looping and bending wire
- Convenient lock for storage also prevents accidental locking and loosening over time

KLEIN-KURVE™



63020

Cat. No.	Cutting Capacity	Screw Shearing	Handle Color	Overall Length	Weight
63020	Up to 12 AWG Solid and Stranded Copper Wire, Up to 0.032" (.081 mm) Diameter Stainless Steel, Up to 1/2" (12.7 mm) Multi-conductor Cable, Coaxial Cable RG-6 Quad, RG-59 and RG-62	6-32 & 8-32	Red	7" (177.8 mm)	0.44 lb (0.20 kg)





Cable Cutters

Utility Cable and Rope Cutters

- Forged steel with black-oxide finish for long life
- Shear-type hook jaws grab and hold cable while shear-cutting action makes clean cuts
- Beveled tips for positive mating
- Hinge bolt with pin-set nut for proper blade tension
- Cat. No. 63035SC cuts wire up to 9/32" (7 mm) and Stoffel® container seals
- Cat. No. 63035 is not designed to cut steel or ACSR



63035

63035SC

Cat. No.	Cutting Capacity	Handle Color	Overall Length	Weight
63035	MCM Cable 350 Copper, 350 Aluminum	Red	16-1/4" (412.8 mm)	1.7 lb (0.8 kg)
63035SC	9/32" (7.1 mm) Wire Rope and Cables	Red	18" (457.2 mm)	2.0 lb (0.9 kg)

Stoffel® is a registered trademark of Stoffel Seals Corporation.

Standard and Communication Cable Cutters

- Lightweight, yet efficient shear-type cable cutters
- Replaceable hook-jaw blades grab and hold cable while shear-cutting action makes clean cuts
- Exceptionally strong fiberglass handles with heavy vinyl grips for comfort and slip resistance
- Heavy-duty pins in head serve as blade-stops
- Jaws are forged tool steel with black-oxide finish for long life
- Beveled tips assure positive mating, and hinge on a rugged bolt with a pin-set nut to maintain proper blade tension
- Makes a clean, even cut for ease in fitting lugs and terminals
- Cat. No. 63041TH includes rubber sleeves
- Cat. No. 63047 cuts lead or rubber-covered communications cable



63041TH

63047

⚠ WARNING: Do NOT cut steel or ACSR.

Cat. No.	Soft Cable Maximum Capacity	MCM Cable Maximum Capacity	Replacement Blade	Overall Length	Weight
63041	1-3/8" (34.9 mm) Diameter	MCM 500 Copper, 750 Aluminum	63081	25-1/2" (647.7 mm)	5.3 lb (2.4 kg)
63041TH	1-3/8" (34.9 mm) Diameter	MCM 500 Copper, 750 Aluminum	63081	25-1/2" (647.7 mm)	5.3 lb (2.4 kg)
63045	1-3/4" (44.5 mm) Diameter	1000 Copper, 1200 Aluminum	63090	32" (812.8 mm)	8.0 lb (3.6 kg)
63047	Up to 2-1/4" (57.2 mm) Diameter	900-Pair Soft Copper and Aluminum	63110	37" (939.8 mm)	8.6 lb (3.9 kg)

See page 295 for additional information on warnings.



Cable Cutters

Ratcheting Cable Cutters

- Reduced hand force for easier cutting
- Patented two-step ratchet mechanism requires fewer strokes per cut
- Quick release lever opens blades easily in every cutting position to allow removal of the cable before completion of cut
- Hardened steel cutting blades for lasting strength and sharpness
- Locking lever keeps handles closed for easy transport; fits in a toolbox or bag

⚠WARNING: Do NOT cut steel or ACSR.



Replacement parts available

(blades, handles, springs, pawl sets and release plates).
Go to www.kleintools.com or call 800-553-4676 for a full listing of replacement parts.

Cat. No.	MCM Maximum Cable Capacity (Aluminum)	MCM Maximum Cable Capacity (Copper)	MCM Maximum Cable Capacity (Communication Cable)	Overall Length	Handle Color	Weight
63060	750 MCM (380 mm ²)	600 MCM (300 mm ²)	1-1/8" (28.6 mm)	10-1/4" (260.4 mm)	Red	1.3 lb (0.6 kg)
63711	750 MCM (400 mm ²)	600 MCM (300 mm ²)	1-1/8" (28.6 mm)	11-1/2" (292.1 mm)	Red	2.0 lb (0.9 kg)
63750	1000 MCM (500 mm ²), Frequent Use: 750 MCM (400 mm ²)	1000 MCM (500 mm ²), Frequent Use: 750 MCM (400 mm ²)	2-1/16" (52.4 mm)	12-1/8" (308.0 mm)	Red	1.8 lb (0.8 kg)
63601	1000 MCM (500 mm ²)	600 MCM (300 mm ²)	2-1/16" (52.4 mm)	10-1/4" (260.4 mm)	Red	2.7 lb (1.2 kg)

ACSR Ratcheting Cable Cutter

- High-leverage ratcheting mechanism for easier cutting
- Quick-release lever opens blades easily in every cutting position. (Allows removal of the cable before completion of cut)
- Hardened steel cutting blades for long lasting strength and sharpness
- Tools can be locked when not in use
- Cat. No. 63800ACSR features cutting inserts with screws

Replacement parts available

(blades, handles, springs, pawl sets and release plates).
Go to www.kleintools.com or call 800-553-4676 for a full listing of replacement parts.

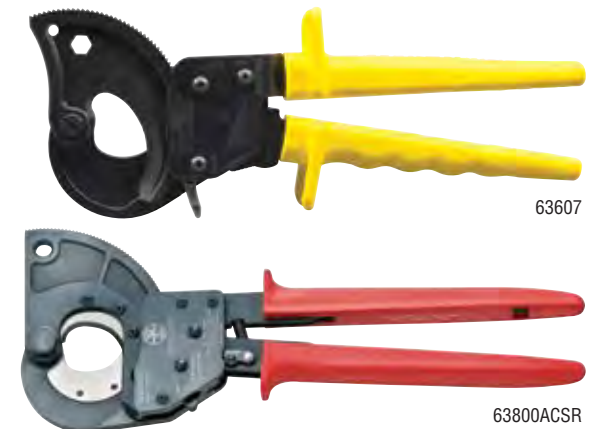

Cat. No.	MCM Maximum Cable Capacity (ACSR)	MCM Maximum Cable Capacity (Aluminum)	MCM Maximum Cable Capacity (Copper)	MCM Maximum Cable Capacity (Guy Strand)	Handle Color	Overall Length	Weight
63607	336 MCM (170 mm ²)	600 MCM (300 mm ²)	400 MCM (185 mm ²)	—	Yellow	10-1/4" (260.4 mm)	1.5 lb (0.7 kg)
63800ACSR	477 MCM (273 mm ²)	1-1/4" (31.8 mm)	1" (25.4 mm)	1/2" (12.7 mm)	Red	13-3/4" (349.3 mm)	3.2 lb (1.5 kg)





Cable Cutters

Ratcheting ACSR Cable Cutter - Heavy-Duty



- Ratchet-action design provides maximum leverage with minimum effort for heavy-duty use
- Forged, heat-treated, shear-type blades, plus 24" (610 mm) long fiberglass handles with heavy duty grips for comfort and slip resistance
- Blade-advance knob for fast rotation of the blade to engage the cable or other material being cut
- Quick-release mechanism allows for removal of the cable or rod before completion of the cut, if desired
- Not designed for cutting EHS guy strand or reinforcement rod
- Cuts steel and ACSR

63700

Cat. No.	Soft Cable Maximum Capacity	Steel Cable Maximum Capacity	Handle Color	Overall Length	Weight
63700	2-1/4" (57.2 mm) Diameter, 750 MCM (1-3/8" [34.9 mm] Diameter, Copper or Aluminum	1-1/4" (31.8 mm) Diameter ACSR, ACAR, 7/16" (11.1 mm) Diameter Common Guy Strand, 5/8" (15.9 mm) Diameter Steel Wire Rope, 1/2" (12.7 mm) Diameter Steel Rod (C.R.S. SOFT)	Yellow	28" (711.2 mm)	14.0 lb (6.4 kg)

Cable Tools

Cable Benders

- Durable forged and one-piece steel construction for exceptional strength
- Head is angled 22° for ease in bending cable in tight, hard-to-access places
- Corrosion-resistant, black-oxide finish with heavy-duty double-dipped plastic handle
- It is recommended that two benders be used for easier bends



50400

Cat. No.	Overall Length	Maximum Cable Capacity	Tool Opening	Weight
50400	12" (304.8 mm)	350 MCM	7/8" (22.2 mm)	0.90 lb (0.41 kg)
50402	14-1/2" (368.3 mm)	500 MCM	1-1/64" (25.8 mm)	1.6 lb (0.7 kg)

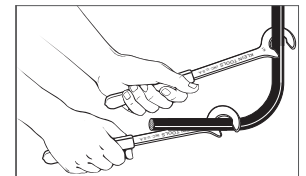

Bolt Cutters

Heavy-Duty Ratcheting Bolt Cutter

- Spring-loaded cable retention hook snaps onto the cable in one hands-free motion and keeps strands between cutting blades
- Long handles provide leverage when cutting
- Lockplate reinforcement prevents jaw bolts from loosening or turning, keeps jaws in correct alignment
- Up to HRC Rockwell C31, Rockwell C42



63RBCHD

EASY AS



OPEN

movable handle to full extension to open cutting jaws



SNAP

cable between cutting jaws



CUT

cable using ratcheting handle

Cat. No.	Cutting Capacity	Overall Length	Weight
63RBCHD	5/8" (15.9 mm) Ground Rod, 1/2" (12.7 mm) Rebar, 7/16" (11.1 mm) Grade 8 Bolts, 1/2" (12.7 mm) Grade 5 Bolts, 1/2" (12.7 mm) Utility-Grade Guy Strand, 3/8" (9.5 mm) EHS	31" (787.4 mm)	10.0 lb (4.5 kg)

Bolt Cutters - Steel and Fiberglass Handle

- All-purpose, center-cut jaws
- Forged, alloy tool steel jaws are precision ground for sure, efficient cutting and long life
- Lock plate reinforcement prevents jaw bolts from loosening or turning, keeping jaws in correct alignment
- **NOT for cutting cable**



63314

63118

Cat. No.	Soft & Medium Cutting Max Capacity	Hard Material Cutting Max Capacity	Handle Material	Replacement Blade	Overall Length	Weight
63314	5/16" (7.9 mm)	3/16" (4.8 mm)	Steel	63814	14" (355.6 mm)	3.2 lb (1.4 kg)
63318	3/8" (9.5 mm)	1/4" (6.4 mm)	Steel	63938	18" (457.2 mm)	3.6 lb (1.6 kg)
63324	7/16" (11.1 mm)	5/16" (7.9 mm)	Steel	63824	24" (609.6 mm)	6.3 lb (2.9 kg)
63330	1/2" (12.7 mm)	3/8" (9.5 mm)	Steel	63831	30" (762.0 mm)	10.2 lb (4.6 kg)
63336	9/16" (14.3 mm)	7/16" (11.1 mm)	Steel	63836	36" (914.4 mm)	14.3 lb (6.5 kg)
63342	11/16" (17.5 mm)	1/2" (12.7 mm)	Steel	63842	42" (106.7 cm)	19.2 lb (8.7 kg)
63118	3/8" (9.5 mm)	1/4" (6.4 mm)	Fiberglass	63918	18-1/4" (463.6 mm)	3.7 lb (1.7 kg)
63124	7/16" (11.1 mm)	5/16" (7.9 mm)	Fiberglass	63924	24-1/2" (622.3 mm)	6.1 lb (2.8 kg)
63130	1/2" (12.7 mm)	3/8" (9.5 mm)	Fiberglass	63930	30-1/2" (774.7 mm)	9.5 lb (4.3 kg)
63136	1/2" (12.7 mm)	3/8" (9.5 mm)	Fiberglass	63137	36-1/2" (927.1 mm)	13.0 lb (5.9 kg)

* Up to Brinell 300, Rockwell C31., ** Up to Brinell 400, Rockwell C42.



Cable and Bolt Cutters

Klein exceeds the highest standards to create superior cable and bolt cutters, offering greater cutting power, clean and precise cuts, as well as long life. Klein cable and bolt cutters are a cut above the rest.



For Professionals...
Since 1857™



Plastic-dipped handles for comfort and ease of identification

FORGED STEEL
from Klein's US-made, proprietary blend

Cable Cutters

Hot-riveted joint ensures smooth action and no handle wobble

Through-hardened (not case-hardened) for longer-lasting cutting surfaces

Beveled jaw tips provide proper mating and shearing action, which protects leading jaw edges



High-Leverage Cable Cutters

Includes core cable cutter features plus:

- High-leverage design for exceptional cutting capability
- Precision, one-hand shearing action
- Cable-gripping shear-type jaws
- Perfect for working in confined spaces
- Fits in most tool pouches/belts



63050



Plastic-Dipped

JOURNEYMAN™
Dual-Material

Refer to the insulated section for insulated cable cutters.

Cat. No.	Cutting Capacity	Handle Color	Handle Finish	Overall Length	Weight
63050	4/0 Aluminum, 2/0 Soft Copper, 100-Pair 24 AWG Communications Cable	Red	Plastic-dipped	9-1/2" (241.3 mm)	0.90 lb (0.41 kg)
J63050	4/0 Aluminum, 2/0 Soft Copper, 100-Pair 24 AWG Communications Cable	Red/Black	Journeyman	9-9/16" (242.9 mm)	0.98 lb (0.44 kg)

Cable Cutters - Coaxial

Includes core cable cutter features plus:

- Cable-gripping jaws quickly score jacket and insulation, and easily cut through copper inner conductor
- Blades cleanly cut aluminum and copper coaxial cable without compression and frayed ends
- Forged body with heat-treated and precision-ground steel blade withstands frequent cutting
- Hot-riveted design requires no adjustment while maintaining a smooth, precise operation
- Compact, lightweight design fits perfectly in any professional's tool pouch
- When cutting drop wire with an inner steel conductor, we recommend our 2000 Series cutting pliers



63028



63030

Cat. No.	Cutting Capacity	Handle Color	Handle Finish	Overall Length	Weight
63028	3/4" (19.1 mm)	Yellow	Plastic-dipped	8-1/4" (209.6 mm)	0.80 lb (0.36 kg)
63030	1" (25.4 mm)	Blue	Plastic-dipped	8-1/4" (209.6 mm)	0.83 lb (0.38 kg)

See page 295 for additional information on warnings.



WARNING: Do NOT cut steel or ACSR.

Cable Cutters

Compact Cable Cutter

Includes core cable cutter features plus:

- Precise, one-hand shearing action cuts 24 AWG copper, aluminum multi-strand cable and wire, and 100-pair telephone cable
- Special shear angle cuts cleanly without compression to cable geometry for telecom cable work
- Heat-treated, high-carbon steel shearing edges for long life
- Forged body with 3/8" (10 mm) case-hardened rivet



63055

⚠WARNING: Do NOT cut steel or ACSR.

Cat. No.	Cutting Capacity	Handle Color	Handle Finish	Overall Length	Weight
63055	24 AWG Copper, Aluminum Multi-Strand Cable and Wire, and 100-Pair Telephone Cable	Red	Plastic-dipped	8" (203.2 mm)	0.65 lb (0.29 kg)

All-Purpose Shears and BX Cutter

Includes core cable cutter features plus:

- Handle cavity is designed to restore BX cable to original shape after cutting
- Stripping notch for added convenience
- High-leverage, shear-type design for one-hand operation
- Lightweight and compact



1104

⚠WARNING: Do NOT cut steel or ACSR.

Cat. No.	Cutting Capacity	Handle Color	Handle Finish	Overall Length	Weight
1104	Cuts BX Cable, Sheet Metal, Steel Strapping and Bundling Wire	Red	Plastic Dipped	7-5/8" (193.7 mm)	0.60 lb (0.27 kg)

Heavy-Duty Cable Shears

- Cuts ACSR, steel, and most hardened wire
- Heavy-duty, tempered steel blades
- Blades grip cable and cut easily at center of jaws
- Lock keeps handles closed for easy storage
- Comfortable, plastic-coated handles for steady grip
- Hardened steel, precision cutting blades for long service life
- Unique triangular jaws cleanly cut cable without compression or frayed ends



63016

Cat. No.	Cutting Capacity	Handle Color	Handle Finish	Overall Length	Weight
63016	Up to 1/4" (6.4 mm) Copper and Mild Steel Strands, up to 3/16" (4.8 mm) Aircraft Cable, Wire Rope, Aluminum and Copper Rods, up to 5/32" (4 mm) for Steel and Iron Rods	Blue	Plastic-dipped	7-1/2" (190.5 mm)	0.65 lb (0.29 kg)

Multi-Cable Cutter

- Hardened steel precision-ground cutting blades for long life
- Copper curved cutter cleanly cuts round copper cable without compression or frayed ends
- Double-dipped grips for comfort
- Coil spring provides fast self-opening action
- Holes for looping and bending wire
- Convenient lock for storage also prevents accidental locking and loosening over time

KLEIN-KURVE™



63020

Cat. No.	Cutting Capacity	Screw Shearing	Handle Color	Overall Length	Weight
63020	Up to 12 AWG Solid and Stranded Copper Wire, Up to 0.032" (.081 mm) Diameter Stainless Steel, Up to 1/2" (12.7 mm) Multi-conductor Cable, Coaxial Cable RG-6 Quad, RG-59 and RG-62	6-32 & 8-32	Red	7" (177.8 mm)	0.44 lb (0.20 kg)





Cable Cutters

Utility Cable and Rope Cutters

- Forged steel with black-oxide finish for long life
- Shear-type hook jaws grab and hold cable while shear-cutting action makes clean cuts
- Beveled tips for positive mating
- Hinge bolt with pin-set nut for proper blade tension
- Cat. No. 63035SC cuts wire up to 9/32" (7 mm) and Stoffel® container seals
- Cat. No. 63035 is not designed to cut steel or ACSR



63035

63035SC

Cat. No.	Cutting Capacity	Handle Color	Overall Length	Weight
63035	MCM Cable 350 Copper, 350 Aluminum	Red	16-1/4" (412.8 mm)	1.7 lb (0.8 kg)
63035SC	9/32" (7.1 mm) Wire Rope and Cables	Red	18" (457.2 mm)	2.0 lb (0.9 kg)

Stoffel® is a registered trademark of Stoffel Seals Corporation.

Standard and Communication Cable Cutters

- Lightweight, yet efficient shear-type cable cutters
- Replaceable hook-jaw blades grab and hold cable while shear-cutting action makes clean cuts
- Exceptionally strong fiberglass handles with heavy vinyl grips for comfort and slip resistance
- Heavy-duty pins in head serve as blade-stops
- Jaws are forged tool steel with black-oxide finish for long life
- Beveled tips assure positive mating, and hinge on a rugged bolt with a pin-set nut to maintain proper blade tension
- Makes a clean, even cut for ease in fitting lugs and terminals
- Cat. No. 63041TH includes rubber sleeves
- Cat. No. 63047 cuts lead or rubber-covered communications cable



63041TH

63047

⚠ WARNING: Do NOT cut steel or ACSR.

Cat. No.	Soft Cable Maximum Capacity	MCM Cable Maximum Capacity	Replacement Blade	Overall Length	Weight
63041	1-3/8" (34.9 mm) Diameter	MCM 500 Copper, 750 Aluminum	63081	25-1/2" (647.7 mm)	5.3 lb (2.4 kg)
63041TH	1-3/8" (34.9 mm) Diameter	MCM 500 Copper, 750 Aluminum	63081	25-1/2" (647.7 mm)	5.3 lb (2.4 kg)
63045	1-3/4" (44.5 mm) Diameter	1000 Copper, 1200 Aluminum	63090	32" (812.8 mm)	8.0 lb (3.6 kg)
63047	Up to 2-1/4" (57.2 mm) Diameter	900-Pair Soft Copper and Aluminum	63110	37" (939.8 mm)	8.6 lb (3.9 kg)

See page 295 for additional information on warnings.



Cable Cutters

Ratcheting Cable Cutters

- Reduced hand force for easier cutting
- Patented two-step ratchet mechanism requires fewer strokes per cut
- Quick release lever opens blades easily in every cutting position to allow removal of the cable before completion of cut
- Hardened steel cutting blades for lasting strength and sharpness
- Locking lever keeps handles closed for easy transport; fits in a toolbox or bag

⚠WARNING: Do NOT cut steel or ACSR.



Replacement parts available

(blades, handles, springs, pawl sets and release plates).
Go to www.kleintools.com or call 800-553-4676 for a full listing of replacement parts.

Cat. No.	MCM Maximum Cable Capacity (Aluminum)	MCM Maximum Cable Capacity (Copper)	MCM Maximum Cable Capacity (Communication Cable)	Overall Length	Handle Color	Weight
63060	750 MCM (380 mm ²)	600 MCM (300 mm ²)	1-1/8" (28.6 mm)	10-1/4" (260.4 mm)	Red	1.3 lb (0.6 kg)
63711	750 MCM (400 mm ²)	600 MCM (300 mm ²)	1-1/8" (28.6 mm)	11-1/2" (292.1 mm)	Red	2.0 lb (0.9 kg)
63750	1000 MCM (500 mm ²), Frequent Use: 750 MCM (400 mm ²)	1000 MCM (500 mm ²), Frequent Use: 750 MCM (400 mm ²)	2-1/16" (52.4 mm)	12-1/8" (308.0 mm)	Red	1.8 lb (0.8 kg)
63601	1000 MCM (500 mm ²)	600 MCM (300 mm ²)	2-1/16" (52.4 mm)	10-1/4" (260.4 mm)	Red	2.7 lb (1.2 kg)

ACSR Ratcheting Cable Cutter

- High-leverage ratcheting mechanism for easier cutting
- Quick-release lever opens blades easily in every cutting position. (Allows removal of the cable before completion of cut)
- Hardened steel cutting blades for long lasting strength and sharpness
- Tools can be locked when not in use
- Cat. No. 63800ACSR features cutting inserts with screws

Replacement parts available

(blades, handles, springs, pawl sets and release plates).
Go to www.kleintools.com or call 800-553-4676 for a full listing of replacement parts.

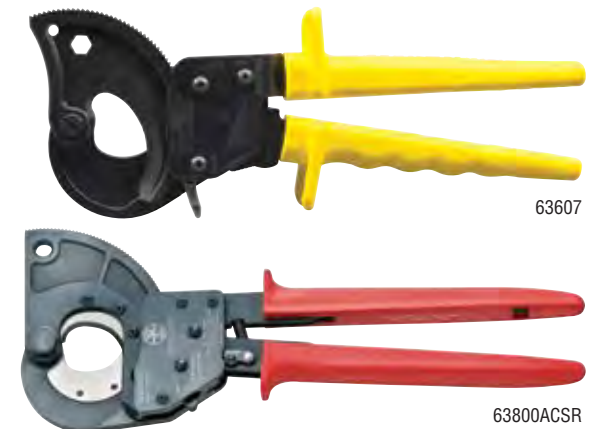

Cat. No.	MCM Maximum Cable Capacity (ACSR)	MCM Maximum Cable Capacity (Aluminum)	MCM Maximum Cable Capacity (Copper)	MCM Maximum Cable Capacity (Guy Strand)	Handle Color	Overall Length	Weight
63607	336 MCM (170 mm ²)	600 MCM (300 mm ²)	400 MCM (185 mm ²)	—	Yellow	10-1/4" (260.4 mm)	1.5 lb (0.7 kg)
63800ACSR	477 MCM (273 mm ²)	1-1/4" (31.8 mm)	1" (25.4 mm)	1/2" (12.7 mm)	Red	13-3/4" (349.3 mm)	3.2 lb (1.5 kg)





Cable Cutters

Ratcheting ACSR Cable Cutter - Heavy-Duty



- Ratchet-action design provides maximum leverage with minimum effort for heavy-duty use
- Forged, heat-treated, shear-type blades, plus 24" (610 mm) long fiberglass handles with heavy duty grips for comfort and slip resistance
- Blade-advance knob for fast rotation of the blade to engage the cable or other material being cut
- Quick-release mechanism allows for removal of the cable or rod before completion of the cut, if desired
- Not designed for cutting EHS guy strand or reinforcement rod
- Cuts steel and ACSR

63700

Cat. No.	Soft Cable Maximum Capacity	Steel Cable Maximum Capacity	Handle Color	Overall Length	Weight
63700	2-1/4" (57.2 mm) Diameter, 750 MCM (1-3/8" [34.9 mm] Diameter, Copper or Aluminum)	1-1/4" (31.8 mm) Diameter ACSR, ACAR, 7/16" (11.1 mm) Diameter Common Guy Strand, 5/8" (15.9 mm) Diameter Steel Wire Rope, 1/2" (12.7 mm) Diameter Steel Rod (C.R.S. SOFT)	Yellow	28" (711.2 mm)	14.0 lb (6.4 kg)

Cable Tools

Cable Benders

- Durable forged and one-piece steel construction for exceptional strength
- Head is angled 22° for ease in bending cable in tight, hard-to-access places
- Corrosion-resistant, black-oxide finish with heavy-duty double-dipped plastic handle
- It is recommended that two benders be used for easier bends



50400

Cat. No.	Overall Length	Maximum Cable Capacity	Tool Opening	Weight
50400	12" (304.8 mm)	350 MCM	7/8" (22.2 mm)	0.90 lb (0.41 kg)
50402	14-1/2" (368.3 mm)	500 MCM	1-1/64" (25.8 mm)	1.6 lb (0.7 kg)

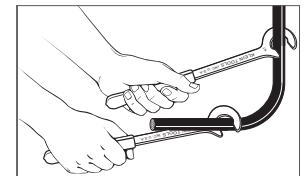

Bolt Cutters

Heavy-Duty Ratcheting Bolt Cutter

- Spring-loaded cable retention hook snaps onto the cable in one hands-free motion and keeps strands between cutting blades
- Long handles provide leverage when cutting
- Lockplate reinforcement prevents jaw bolts from loosening or turning, keeps jaws in correct alignment
- Up to HRC Rockwell C31, Rockwell C42



63RBCHD

EASY AS



OPEN

movable handle to full extension to open cutting jaws



SNAP

cable between cutting jaws



CUT

cable using ratcheting handle

Cat. No.	Cutting Capacity	Overall Length	Weight
63RBCHD	5/8" (15.9 mm) Ground Rod, 1/2" (12.7 mm) Rebar, 7/16" (11.1 mm) Grade 8 Bolts, 1/2" (12.7 mm) Grade 5 Bolts, 1/2" (12.7 mm) Utility-Grade Guy Strand, 3/8" (9.5 mm) EHS	31" (787.4 mm)	10.0 lb (4.5 kg)

Bolt Cutters - Steel and Fiberglass Handle

- All-purpose, center-cut jaws
- Forged, alloy tool steel jaws are precision ground for sure, efficient cutting and long life
- Lock plate reinforcement prevents jaw bolts from loosening or turning, keeping jaws in correct alignment
- **NOT for cutting cable**



63314

63118

Cat. No.	Soft & Medium Cutting Max Capacity	Hard Material Cutting Max Capacity	Handle Material	Replacement Blade	Overall Length	Weight
63314	5/16" (7.9 mm)	3/16" (4.8 mm)	Steel	63814	14" (355.6 mm)	3.2 lb (1.4 kg)
63318	3/8" (9.5 mm)	1/4" (6.4 mm)	Steel	63938	18" (457.2 mm)	3.6 lb (1.6 kg)
63324	7/16" (11.1 mm)	5/16" (7.9 mm)	Steel	63824	24" (609.6 mm)	6.3 lb (2.9 kg)
63330	1/2" (12.7 mm)	3/8" (9.5 mm)	Steel	63831	30" (762.0 mm)	10.2 lb (4.6 kg)
63336	9/16" (14.3 mm)	7/16" (11.1 mm)	Steel	63836	36" (914.4 mm)	14.3 lb (6.5 kg)
63342	11/16" (17.5 mm)	1/2" (12.7 mm)	Steel	63842	42" (106.7 cm)	19.2 lb (8.7 kg)
63118	3/8" (9.5 mm)	1/4" (6.4 mm)	Fiberglass	63918	18-1/4" (463.6 mm)	3.7 lb (1.7 kg)
63124	7/16" (11.1 mm)	5/16" (7.9 mm)	Fiberglass	63924	24-1/2" (622.3 mm)	6.1 lb (2.8 kg)
63130	1/2" (12.7 mm)	3/8" (9.5 mm)	Fiberglass	63930	30-1/2" (774.7 mm)	9.5 lb (4.3 kg)
63136	1/2" (12.7 mm)	3/8" (9.5 mm)	Fiberglass	63137	36-1/2" (927.1 mm)	13.0 lb (5.9 kg)

* Up to Brinell 300, Rockwell C31., ** Up to Brinell 400, Rockwell C42.

