

Type MTC

Machine Tool Conduit
Liquid-Tight Flexible Metal Conduit (LFMC)



Construction

- Constructed of continuously interlocked hot dipped zinc galvanized steel core for exceptional crush and corrosion resistance.
- Durable, sunlight resistant thermoplastic PVC jacket that resists heat, oil and chemical breakdown.

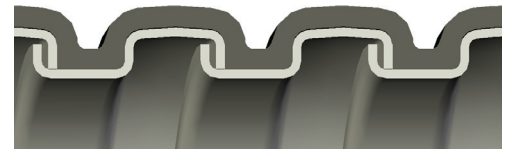

Square-Locked Design 3/8" through 2"

Installation

- Conduit used with standard liquid-tight fitting for easy installation. IP 65 Rated when installed with approved fittings.
- Delivers superior wiring protection where agency approvals are not required.
- Manufactured in a full range of trade sizes from 3/8" through 2".
- Smooth appearing jacket for exposed applications.
- Rated for temperature range of -4°F to +140°F (-20°C to +60°C).
- Provides liquid-tight raceway for electrical conductors.

See pages 23-28 for fittings



• RoHS WEEE COMPLIANT

Type MTC

Black thermoplastic PVC jacket



Product Specifications

Ordering Information

Electrical Trade Size		Inside Diameter		Outside Diameter		Approx Inside Bend Radius	Approx Weight lbs.	Standard Carton		Small Reels	
Inches	mm	Inches		Inches				PER	Length	NAED	Length
		MIN.	MAX.	MIN.	MAX.		100 FT.	Feet	PIN	Feet	PIN
3/8	12	.485	-.505	.679	-.704	1.5	16	100	38302	800	38304
1/2	16	.620	-.640	.818	-.843	2.0	20	100	38312	500	38314
3/4	21	.815	-.835	1.009	1.034	2.5	24	100	38322	500	38328
1	27	1.030	1.055	1.228	1.258	3.0	30	100	38331	400	38338
1-1/4	35	1.370	1.395	1.565	1.595	3.5	40	50	38341	250	38348
1-1/2	41	1.570	1.595	1.830	1.860	4.0	70	50	38351	150	38354
2	53	2.010	2.035	2.270	2.300	5.0	87	50	38361	100	38368

Note: 1. Other colors available upon request.

TYPICAL SPECIFICATION:

Conduit shall be Anaconda SEALTITE® Type MTC. Conduit shall provide a flexible liquid-tight raceway for wiring and shall be constructed of continuously interlocked hot dipped zinc galvanized steel core with sunlight resistant PVC outer jacket. Type MTC conduit shall be used for applications where agency approvals are not required. Conduit IP 65 rated when installed with approved end fittings.

Type MTC

Machine Tool Conduit
Liquid-Tight Flexible Metal Conduit (LFMC)



Construction

- Constructed of continuously interlocked hot dipped zinc galvanized steel core for exceptional crush and corrosion resistance.
- Durable, sunlight resistant thermoplastic PVC jacket that resists heat, oil and chemical breakdown.

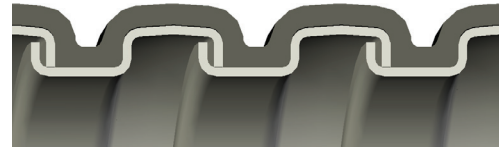

Square-Locked Design 3/8" through 2"

Installation

- Conduit used with standard liquid-tight fitting for easy installation. IP 65 Rated when installed with approved fittings.
- Delivers superior wiring protection where agency approvals are not required.
- Manufactured in a full range of trade sizes from 3/8" through 2".
- Smooth appearing jacket for exposed applications.
- Rated for temperature range of -4°F to +140°F (-20°C to +60°C).
- Provides liquid-tight raceway for electrical conductors.

See pages 23-28 for fittings



• RoHS WEEE COMPLIANT

Type MTC

Black thermoplastic PVC jacket



Product Specifications

Ordering Information

Electrical Trade Size		Inside Diameter		Outside Diameter		Approx Inside Bend Radius	Approx Weight lbs.	Standard Carton		Small Reels	
Inches	mm	Inches		Inches				PER	Length	NAED	Length
		MIN.	MAX.	MIN.	MAX.		100 FT.	Feet	PIN	Feet	PIN
3/8	12	.485	-.505	.679	-.704	1.5	16	100	38302	800	38304
1/2	16	.620	-.640	.818	-.843	2.0	20	100	38312	500	38314
3/4	21	.815	-.835	1.009	1.034	2.5	24	100	38322	500	38328
1	27	1.030	1.055	1.228	1.258	3.0	30	100	38331	400	38338
1-1/4	35	1.370	1.395	1.565	1.595	3.5	40	50	38341	250	38348
1-1/2	41	1.570	1.595	1.830	1.860	4.0	70	50	38351	150	38354
2	53	2.010	2.035	2.270	2.300	5.0	87	50	38361	100	38368

Note: 1. Other colors available upon request.

TYPICAL SPECIFICATION:

Conduit shall be Anaconda SEALTITE® Type MTC. Conduit shall provide a flexible liquid-tight raceway for wiring and shall be constructed of continuously interlocked hot dipped zinc galvanized steel core with sunlight resistant PVC outer jacket. Type MTC conduit shall be used for applications where agency approvals are not required. Conduit IP 65 rated when installed with approved end fittings.